

Submersible Drainage & Sewage Pump 60Hz

Efficient discharge of sewage



Submersible Drainage Pumps

Submersible Sewage/ Effluent Pump
 STAIRS series Submersible Sewage / Effluent /Grinder Pumps are designed for commercial and industrial wastewater transferring and dewatering applications. The innovative vortex impeller design reduces the risk of clogging problem . Moreover, STAIRS series include a stainless steel /cast iron motor frame to prevent corrosion and are designed to provide great heat dissipation from the motor, ensuring a long service life. As with STAIRS pump, each one is 100% tested to ensure quality and reliability for years of trouble-free performance.

Submersible Drainage Pumps

| | |
|----------|----|
| X1 | 01 |
| XD | 03 |
| XV | 05 |
| HM | 07 |
| SD | 09 |
| SV | 12 |
| SVL | 15 |
| SVN | 18 |
| TS/TM/TL | 21 |
| GD | 23 |



Model Code

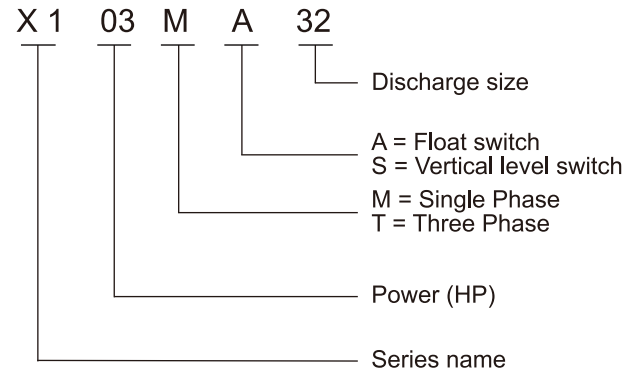

Feature

Compact design with Top Discharge Outlet reduces space usage for installation in small manholes, for use in domestic, installations and small featured works. Two different types of lever sensors :

- Mechanical activated float switch with cable extender (A)
- Vertical Mechanical activated Float Switch with casement (S)

Top discharged cools and removes heat from the motor through the outlet. It allows these pumps to be used even when only partially submerged. Every model undergoes hydrostatic testing for leakage from the casing and mechanical seals.

Applications

- Domestic drainage
- Grey water drainage.
- Koi pond
- Light waste water discharge.
- Hydro-sanitary
- Fountain and landscape
- Drainage pumping.
- Livestocks
- Emergencies flooding pumping

Motor Data

- Motor Type : 2 POLE , dry type
- Frequency : 60Hz
- Nominal Speed : 3450 rpm
- Insulation Class : F class (155°C)

Operation Conditions

- Fluid Temperature: 0 to 50°C (122°F)
- MAX.depth : Maximum 5M

Pump Data

- Enclosure Protection Class : IP 68
- Protection Device : Thermal Protector (Single phase)
- Insulation Class : F class (155°C)
- Bearing : Double sealed with steel cage
- Mechanical seal : unbalance single mechanical seal bath in oil with spring type oil seal
- Impeller : Open Impeller

Material

| No. | Component | Material |
|-----|-----------------|------------------------------------|
| 1 | Cable | H05RN-F |
| 2 | Float switch | Plastic |
| 3 | Handle | NY66+G30 |
| 4 | Motor cover | AISI 304 |
| 5 | Motor housing | AISI 304 |
| 6 | Oil Seal | NBR |
| 7 | Mechanical seal | Carbon Graphite Ceramic / NBR/ 304 |
| 8 | Shaft | AISI 410 |
| 9 | Pump housing | AISI 304 |
| 10 | Impeller | AISI 304 |
| 11 | Pump casing | AISI 304 |
| 12 | Strainer | AISI 304 |
| 13 | Spring washer | AISI 304 |
| 14 | Hex Domed Nuts | AISI 304 |

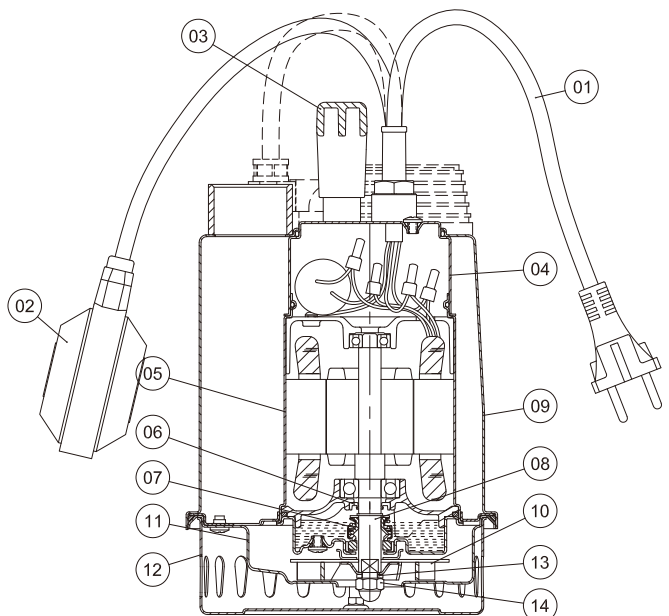

Performance Curves

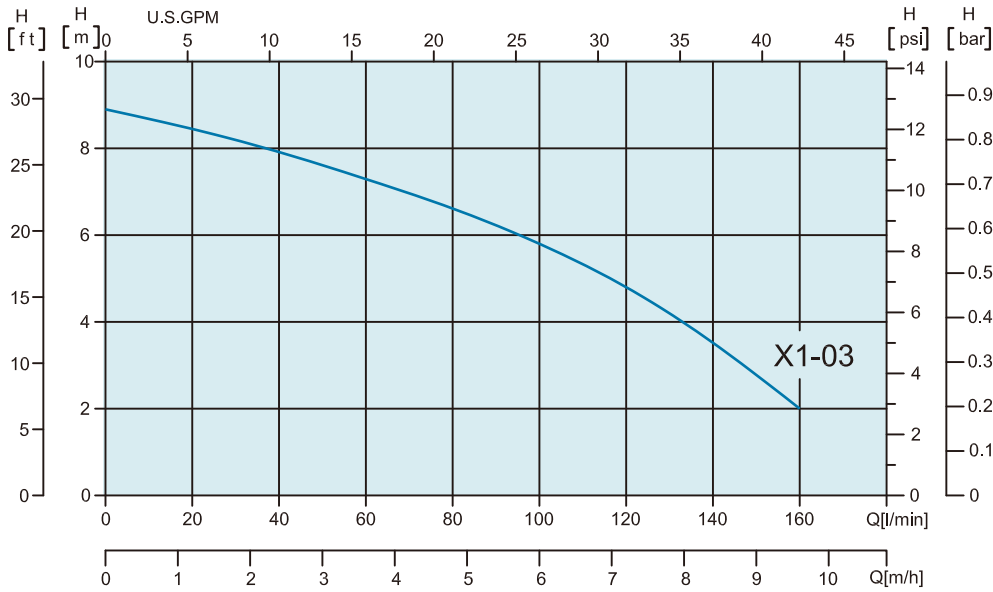

Technical Data

Single Phase

| Model | Power | | Current(A) | | Capacitoret | | Head | | Flow | | Discharge inch |
|------------|-------|------|------------|----------|------------------|------------------|-----------|---------|---------------|-------------|----------------|
| | HP | Kw | 110-127V | 220-230V | 110-127V U F / V | 220-230V U F / V | Rated (M) | Max (M) | Rated (L/min) | Max (L/min) | |
| X1 03M-32 | 0.33 | 0.25 | 4.6-4.0 | 2.1-2.0 | 20UF 250V | 6.3UF 450V | 6.5 | 8.7 | 85 | 160 | 1 1/4" |
| X1 03MA-32 | | | | | | | | | | | |
| X1 03MS-32 | | | | | | | | | | | |

Three Phase

| Model | Power | | Current(A) | | | Head | | Flow | | Discharge inch |
|-----------|-------|------|------------|----------|----------|-----------|---------|---------------|-------------|----------------|
| | HP | Kw | 220-230V | 380-440V | 460-480V | Rated (M) | Max (M) | Rated (L/min) | Max (L/min) | |
| X1 03T-32 | 0.33 | 0.25 | 1.4-1.3 | 0.7-0.6 | 0.6-0.5 | 6.5 | 8.7 | 85 | 160 | 1 1/4" |

Dimensions

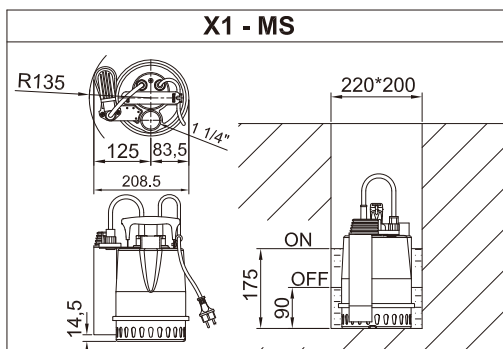
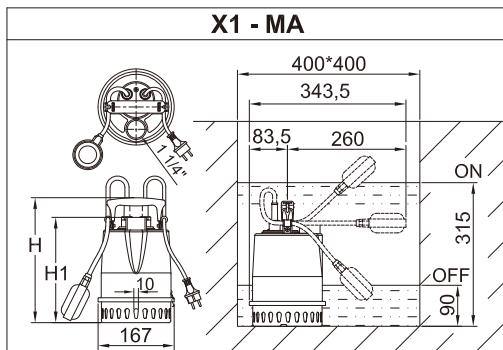

| Model | Discharge[mm] | | Solid Passage [mm] | Cable | | N.W. [kg] |
|------------|---------------|-----|--------------------|-----------|----|-----------|
| | H | H1 | | H05 RN-F | M | |
| X1 03M-32 | 274 | 231 | 10 | 3G0.75mm² | 10 | 5.4 |
| X1 03MA-32 | | | | | | 5.7 |
| X1 03MS-32 | | | | | | 5.8 |
| X1 03T-32 | 274 | 231 | 10 | 4G0.75mm² | 10 | 5.4 |

Optional minimum suction device

The minimum suction device allows to suck the liquid to 3mm from the ground. (starting from at least 10mm)

The automatic playing of the pump doesn't allow to the minimum suction device to suck out the liquid up to 3mm from ground level.

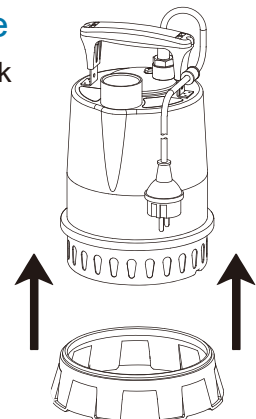



Model Code

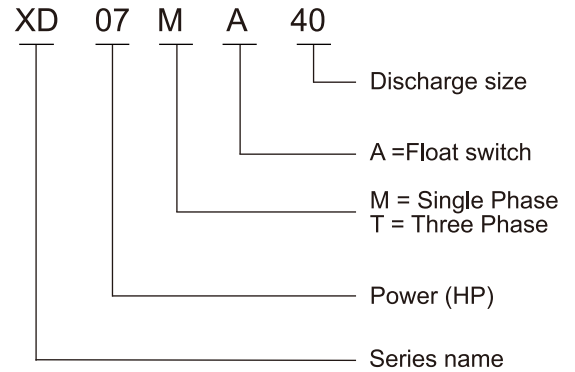

Applications

- Basement water removal
- Waste water drainage
- Water transfer
- Sump/effluent handling
- Dewatering
- Fish pond & fountain circulation
- Factory waste water handling

Motor Data

- Motor Type : 2 POLE , dry type
- Frequency : 60Hz
- Nominal Speed : 3450 rpm
- Insulation Class : F class (155°C)
- Enclosure Protection Class : IP 68
- Protection Device :
Thermal Protector (Single phase)

Pump Data

- Impeller : Open Impeller
- Shaft Seal / Mechanical :
Double Seals
- Bearing :
Double-shielded Ball Bearing

Operation Conditions

- Fluid Temperature: 0 to 50°C (122°F)

Material

| No. | Component | Material |
|-----|-----------------------|--------------------------------|
| 1 | Cable | H07RN-F |
| 2 | Handle | AISI 304+Nylon |
| 3 | Pump Cover | AISI 304 |
| 4 | Motor Cover | AISI 304 |
| 5 | Motor Casing | AISI 304 |
| 6 | Fixing Ring | Nylon+30GF |
| 7 | Pump body | AISI 304 |
| 8 | Mechanical seal | Sic /Sic / NBR |
| 9 | Impeller | AISI 304 |
| 10 | Key | AISI 304 |
| 11 | O-RING | NBR |
| 12 | Oil Seal | NBR |
| 13 | Shaft | AISI 304 |
| 14 | V-type Axial Oil Seal | NBR |
| 15 | Suction flange | AISI 304 |
| | | Thermoplastic polyurethane TPU |
| 16 | Strainer | AISI 304 |

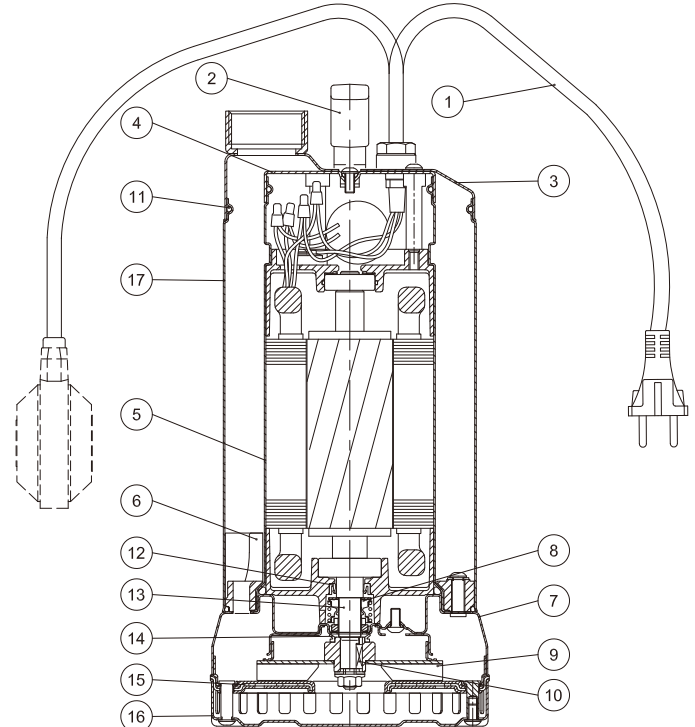

Performance Curves

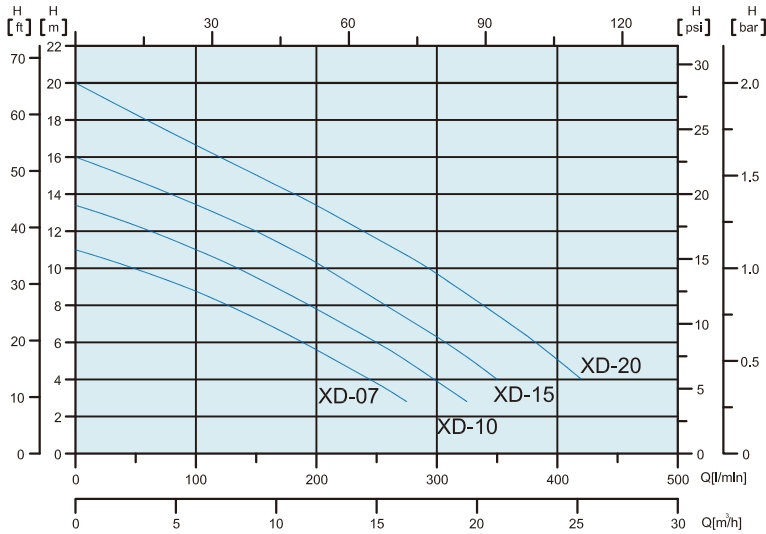

Technical Data

Single Phase

| Model | Power | | Current(A) | | Capacitoret | | Head | | Flow | | Discharge inch |
|-------------|-------|------|------------|----------|----------------------------|----------------------------|-----------|---------|---------------|-------------|----------------|
| | HP | Kw | 110-127V | 220-230V | 110-127V _{UF / V} | 220-230V _{UF / V} | Rated (M) | Max (M) | Rated (L/min) | Max (L/min) | |
| XD 07-M-40 | 0.75 | 0.55 | 8.8-8.0 | 4.7-4.5 | 20UF 350V | 20UF 450V | 8.7 | 11.0 | 100 | 275 | 1 1/2" |
| XD 07-MA-40 | | | | | | | | | | | |
| XD 10-M-40 | 1.0 | 0.75 | 11.0-10.3 | 5.7-5.5 | 35UF 350V | 22UF 450V | 11.0 | 13.4 | 100 | 325 | |
| XD 10-MA-40 | | | | | | | | | | | |
| XD 15-M-40 | 1.5 | 1.1 | - | 8.0-7.7 | - | 30UF 450V | 12.0 | 16.0 | 150 | 350 | |
| XD 15-MA-40 | | | | | | | | | | | |

A = Auto Float Switch

Three Phase

| Model | Power | | Current(A) | | | Head | | Flow | | Discharge inch |
|------------|-------|------|------------|----------|----------|-----------|---------|---------------|-------------|----------------|
| | HP | Kw | 220-230V | 380-440V | 460-480V | Rated (M) | Max (M) | Rated (L/min) | Max (L/min) | |
| XD 07-T-40 | 0.75 | 0.55 | 2.4-2.3 | 1.4-1.3 | 1.2-1.0 | 8.7 | 11.0 | 100 | 275 | 1 1/2" |
| XD 10-T-40 | 1.0 | 0.75 | 3.6-3.5 | 2.1-2.0 | 1.8-1.6 | 11.0 | 13.4 | 100 | 325 | |
| XD 15-T-40 | 1.5 | 1.0 | 4.1-4.0 | 2.4-2.3 | 2.3-2.1 | 12.0 | 16.0 | 150 | 350 | |
| XD 20-T-40 | 2.0 | 1.5 | 5.7-5.5 | 3.3-3.1 | 3.0-2.7 | 15.0 | 20.0 | 150 | 420 | |

Dimensions

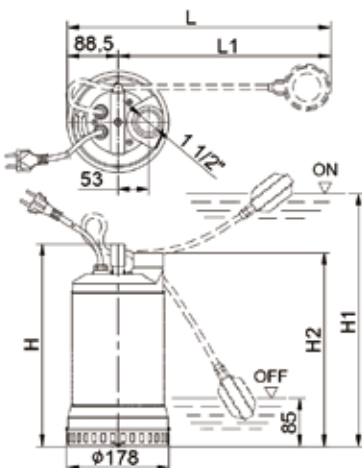

| Model | Discharge[mm] | | | | | Solid Passage [mm] | Cable | | N.W. [kg] |
|-------------|---------------|-----|-----|-----|-----|--------------------|----------------------|----|-----------|
| | H | H1 | H2 | L | L1 | | H07 RN-F | M | |
| XD 07-M-40 | 357 | 437 | 341 | 459 | 370 | 8 | 3G1.0mm ² | 10 | 11.0 |
| XD 07-MA-40 | 357 | 437 | 341 | 459 | 370 | 8 | 3G1.0mm ² | 10 | 11.5 |
| XD 10-M-40 | 407 | 497 | 391 | 514 | 425 | 8 | 3G1.0mm ² | 10 | 14.0 |
| XD 10-MA-40 | 407 | 497 | 391 | 514 | 425 | 8 | 3G1.0mm ² | 10 | 14.5 |
| XD 15-M-40 | 407 | 497 | 391 | 514 | 425 | 8 | 3G1.5mm ² | 10 | 16.0 |
| XD 15-MA-40 | 407 | 497 | 391 | 514 | 425 | 8 | 3G1.5mm ² | 10 | 16.5 |
| XD 07-T-40 | 357 | - | 341 | - | - | 8 | 4G1.0mm ² | 10 | 11.0 |
| XD 10-T-40 | 357 | - | 341 | - | - | 8 | 4G1.0mm ² | 10 | 12.0 |
| XD 15-T-40 | 407 | - | 391 | - | - | 8 | 4G1.0mm ² | 10 | 14.0 |
| XD 20-T-40 | 407 | - | 391 | - | - | 8 | 4G1.5mm ² | 10 | 16.0 |



Model code

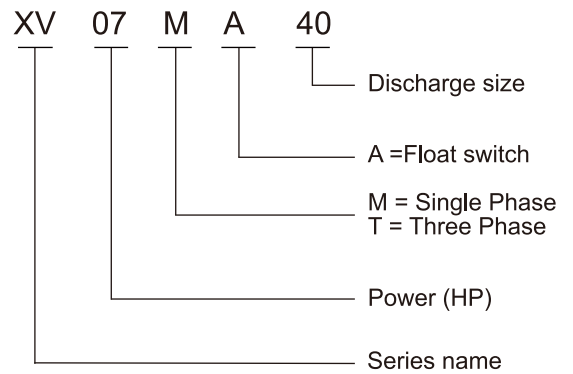

Applications

- Basement water removal
- Waste water drainage
- Water transfer
- Sump/effluent handling
- Dewatering
- Fish pond & fountain circulation
- Factory waste water handling

Motor Data

- Motor Type : 2 POLE , dry type
- Frequency : 60Hz
- Nominal Speed : 3450 rpm
- Insulation Class : F class (155°C)
- Enclosure Protection Class : IP 68
- Protection Device :
Thermal Protector (Single phase)

Pump Data

- Impeller : Vortex Impeller
- Shaft Seal / Mechanical :
Double Seals
- Bearing :
Double-shielded Ball Bearing

Operation Conditions

- Fluid Temperature: 0 to 35°C (95°F)

Material

| No. | Component | Material |
|-----|-----------------------|----------------|
| 1 | Cable | H07RN-F |
| 2 | Handle | AISI 304+Nylon |
| 3 | Motor Cover | AISI 304 |
| 4 | Motor Casing | AISI 304 |
| 5 | Fixing Ring | AISI 304 |
| 6 | Pump Casing | AISI 304 |
| 7 | Mechanical seal | Sic /Sic / NBR |
| 8 | Impeller | AISI 304 |
| 9 | Key | AISI 304 |
| 10 | Support Foot | AISI 304 |
| 11 | Oil Seal | NBR |
| 12 | Shaft | AISI 304 |
| 13 | V-type Axial Oil Seal | NBR |
| 14 | Suction flange | AISI 304 |

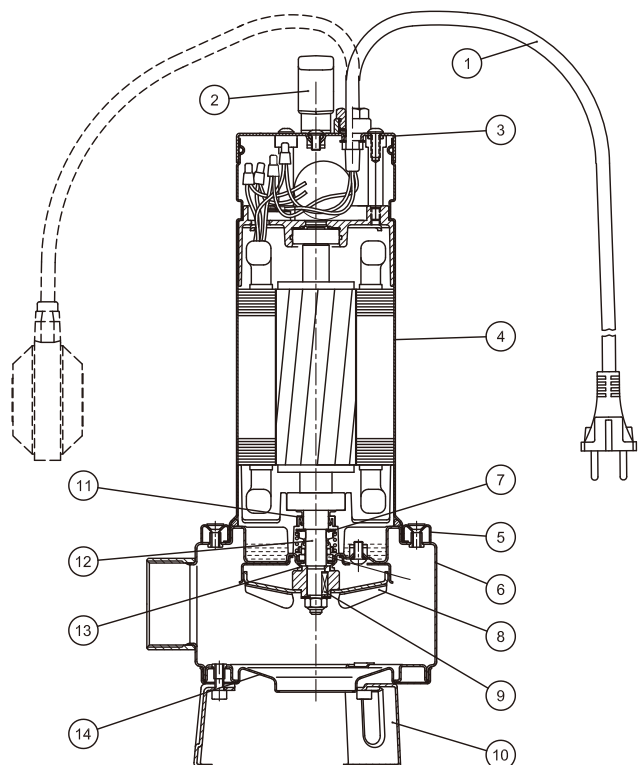

Performance Curves

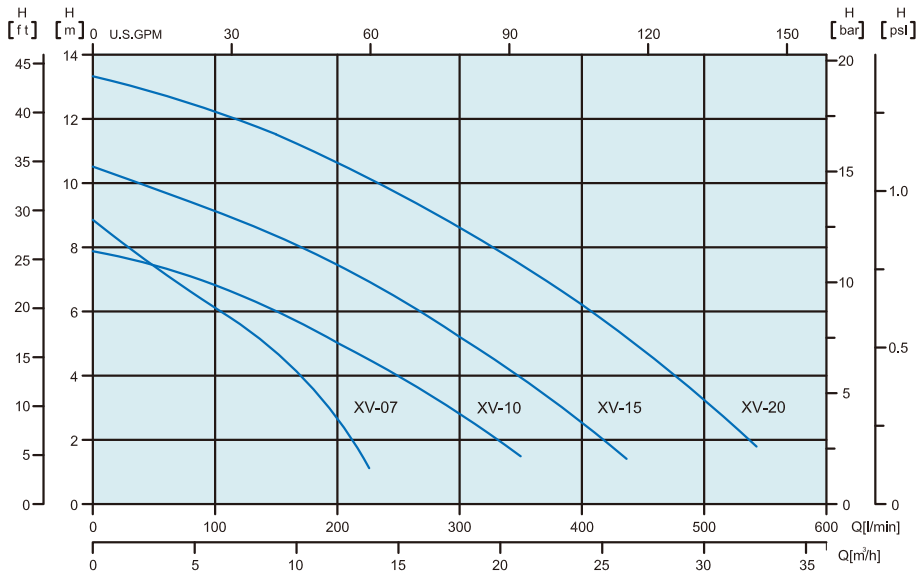

Technical Data

Single Phase

| Model | Power | | Current(A) | | Capacitoret | | Head | | Flow | | Discharge inch |
|-------------|-------|------|------------|----------|--------------------------|--------------------------|-----------|---------|---------------|-------------|----------------|
| | HP | Kw | 110-127V | 220-230V | 110-127V _{UF/V} | 220-230V _{UF/V} | Rated (M) | Max (M) | Rated (L/min) | Max (L/min) | |
| XV 07-M-40 | 0.75 | 0.55 | 8.8-8.0 | 4.7-4.5 | 20UF 350V | 20UF 450V | 6.5 | 8.8 | 80 | 230 | 1 1/2" |
| XV 07-MA-40 | | | | | | | | | | | |
| XV 10-M-50 | 1.0 | 0.75 | 11.0-10.3 | 5.7-5.5 | 35UF 350V | 22UF 450V | 6.8 | 8.0 | 100 | 350 | 2" |
| XV 10-MA-50 | | | | | | | | | | | |
| XV 15-M-50 | 1.5 | 1.1 | - | 8.0-7.7 | - | 30UF 450V | 9.0 | 10.7 | 100 | 430 | |
| XV 15-MA-50 | | | | | | | | | | | |

A = Auto Float Switch

Three Phase

| Model | Power | | Current(A) | | | Head | | Flow | | Discharge inch |
|------------|-------|------|------------|----------|----------|-----------|---------|---------------|-------------|----------------|
| | HP | Kw | 220-230V | 380-440V | 460-480V | Rated (M) | Max (M) | Rated (L/min) | Max (L/min) | |
| XV 07-T-40 | 0.75 | 0.55 | 3.1-3.0 | 1.8-1.7 | 1.7-1.8 | 6.5 | 8.8 | 80 | 230 | 1 1/2" |
| XV 10-T-50 | 1.0 | 0.75 | 4.4-4.2 | 2.5-2.4 | 2.4-2.6 | 6.8 | 8.0 | 100 | 350 | 2" |
| XV 15-T-50 | 1.5 | 1 | 5.0-4.8 | 2.9-2.8 | 2.6-2.8 | 9.0 | 10.5 | 100 | 430 | |
| XV 20-T-50 | 2.0 | 1.5 | 6.2-5.9 | 3.6-3.4 | 3.2-3.3 | 11.5 | 13.5 | 150 | 540 | |

Dimensions

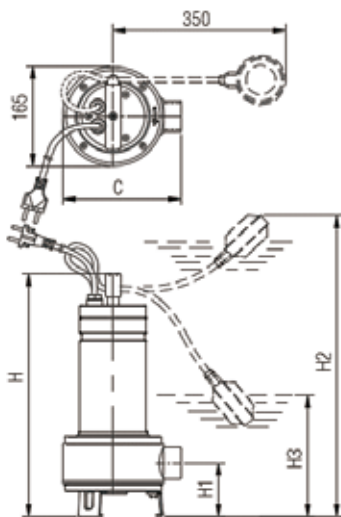

| Model | Discharge[mm] | | | | | Solid Passage [mm] | Cable | | N.W. [kg] |
|-------------|---------------|-------|-----|-----|-----|--------------------|----------------------|----|-----------|
| | H | H1 | H2 | H3 | C | | H07 RN-F | M | |
| XV 07-M-40 | 403 | 88.0 | 483 | 185 | 193 | 35 | 3G1.0mm ² | 5 | 9.0 |
| | | | | | | | | 10 | 10.0 |
| XV 07-MA-40 | 403 | 88.0 | 483 | 185 | 193 | 50 | 3G1.0mm ² | 5 | 10.0 |
| | | | | | | | | 10 | 10.5 |
| XV 10-M-50 | 486 | 111.5 | 566 | 268 | 198 | 50 | 3G1.0mm ² | 10 | 14.0 |
| XV 10-MA-50 | 486 | 111.5 | 566 | 268 | 198 | 50 | 3G1.0mm ² | 10 | 14.5 |
| XV 15-M-50 | 486 | 111.5 | 566 | 268 | 198 | 50 | 3G1.5mm ² | 10 | 16.0 |
| XV 15-MA-50 | 486 | 111.5 | 566 | 268 | 198 | 50 | 3G1.5mm ² | 10 | 16.5 |
| XV 07-T-50 | 403 | 88.0 | - | - | 193 | 35 | 4G1.0mm ² | 5 | 11.0 |
| XV 10-T-50 | 436 | 111.5 | - | - | 198 | 50 | 4G1.0mm ² | 10 | 12.0 |
| XV 15-T-50 | 486 | 111.5 | - | - | 198 | 50 | 4G1.0mm ² | 10 | 14.0 |
| XV 20-T-50 | 486 | 111.5 | - | - | 198 | 50 | 4G1.5mm ² | 10 | 16.0 |



Model Code

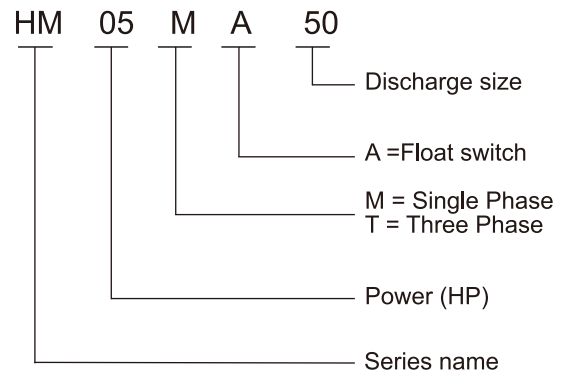

Applications

- Basement water removal
- Waste water drainage
- Water transfer
- Sump/effluent handling
- Dewatering
- Fish pond & fountain circulation
- Factory waste water handling

Motor Data

- Motor Type : 2 POLE , dry type
- Frequency : 60Hz
- Nominal Speed : 3450 rpm
- Insulation Class : F class (155°C)
- Enclosure Protection Class : IP 68
- Protection Device :
Thermal Protector (Single phase)
Overload Protector(Three phase)

Pump Data

- Impeller : Vortex Impeller
- Shaft Seal / Mechanical :
Double Seals
- Bearing :
Double-shielded Ball Bearing

Operation Conditions

- Fluid Temperature: 0 to 40°C (104°F)

Material

| No. | Component | Material |
|-----|-----------------|------------------|
| 1 | Cable | H07RN-F |
| 2 | Handle | Nylon6+30GF |
| 3 | Motor cover | ADC-12 |
| 4 | Bearing cap | SECC |
| 5 | Motor frame | ADC-12 |
| 6 | M.Seal Bracket | FC200 |
| 7 | Cable Base | Nylon6+30GF |
| 8 | Motor Shaft | AISI410 |
| 9 | Mechanical seal | CA / CE, SIC/SIC |
| 10 | Oil Seal | NBR70 |
| 11 | Impeller | TPU |
| 12 | Pump casing | FC200 |
| 13 | Flange | FC200 |

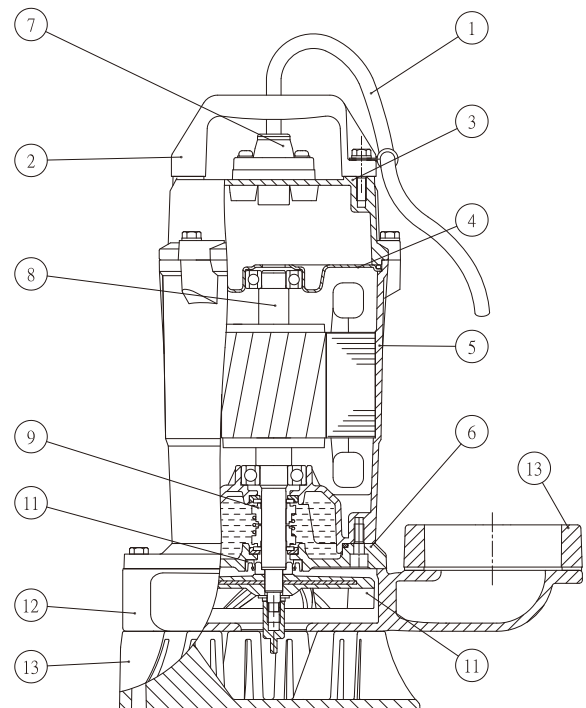

Performance Curves

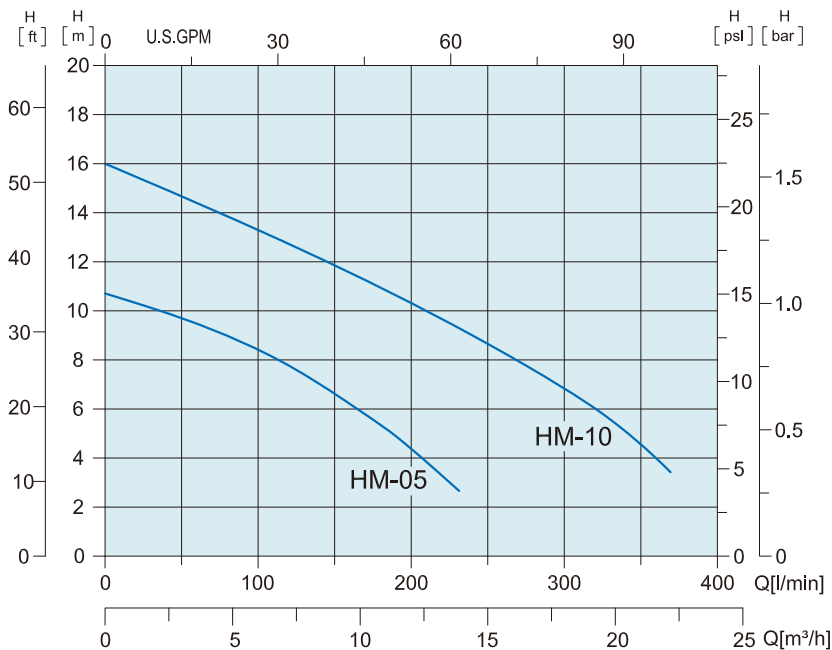

Technical Data

Single Phase

| Model | Power | | Current(A) | | Capacitoret | | Head | | Flow | | Discharge inch |
|-------------|-------|------|------------|----------|--------------------|--------------------|--------------|------------|------------------|----------------|-------------------|
| | HP | Kw | 110-127V | 220-230V | 110-127V UF / V | 220-230V UF / V | Rated (M) | Max (M) | Rated (L/min) | Max (L/min) | |
| HM 05-M-50 | 0.5 | 0.37 | 5.6-4.9 | 2.6-2.5 | 50uF 250V | 12uF 450V | 7.0 | 11.9 | 140 | 230 | 2" |
| HM 05-MA-50 | | | | | | | | | | | |
| HM 10-M-50 | 1.0 | 0.75 | 10.8-9.4 | 5.4-5.2 | 80uF 250V | 20uF 450V | 10.0 | 17.2 | 190 | 316 | 2" |
| HM 10-MA-50 | | | | | | | | | | | |
| HM 10-M-80 | 1.0 | 0.75 | 10.8-9.4 | 5.4-5.2 | 80uF 250V | 20uF 450V | 10.0 | 17.2 | 190 | 316 | 3" |
| HM 10-MA-80 | | | | | | | | | | | |

Three Phase

| Model | Power | | Current(A) | | | Head | | Flow | | Discharge inch |
|------------|-------|------|------------|----------|----------|--------------|------------|------------------|----------------|-------------------|
| | HP | Kw | 220-230V | 380-440V | 460-480V | Rated (M) | Max (M) | Rated (L/min) | Max (L/min) | |
| HM 05-T-50 | 0.5 | 0.37 | 2.1-2.0 | 1.2-1.1 | 1.2-1.0 | 7.0 | 11.9 | 140 | 230 | 2" |
| HM 10-T-50 | 1.0 | 0.75 | 3.3-3.2 | 1.9-1.8 | 1.8-1.6 | 10.0 | 17.2 | 190 | 316 | 2" |
| HM 10-T-80 | 1.0 | 0.75 | 3.3-3.2 | 1.9-1.8 | 1.8-1.6 | 10.0 | 17.2 | 190 | 316 | 3" |

Dimensions

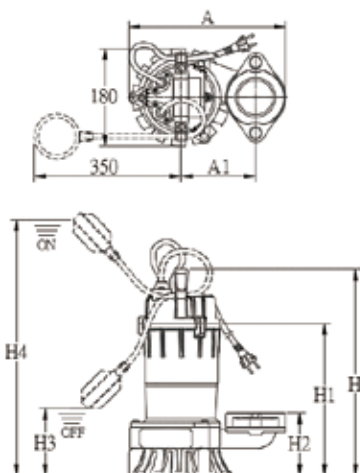

| Model | Discharge[mm] | | | | | | | Solid Passage [mm] | Cable | | N.W. [kg] |
|-------------|---------------|-----|-----|-----|-----|-----|-----|--------------------------|-------|----------------------|--------------|
| | H | H1 | H2 | H3 | H4 | A | A1 | | M | H07 RN-F | |
| HM 05-M-50 | 365 | 264 | 110 | 115 | 535 | 254 | 120 | 10 | 10 | 3G1.0mm ² | 12.9 |
| HM 05-MA-50 | 365 | 264 | 110 | 115 | 535 | 254 | 120 | 10 | 10 | 3G1.0mm ² | 13.4 |
| HM 10-M-50 | 380 | 279 | 116 | 130 | 550 | 285 | 135 | 10 | 10 | 3G1.0mm ² | 15.1 |
| HM 10-MA-50 | 380 | 279 | 116 | 130 | 550 | 285 | 135 | 10 | 10 | 3G1.0mm ² | 15.6 |
| HM 10-M-80 | 380 | 279 | 116 | 130 | 550 | 285 | 135 | 10 | 10 | 3G1.0mm ² | 15.1 |
| HM 10-MA-80 | 380 | 279 | 116 | 130 | 550 | 285 | 135 | 10 | 10 | 3G1.0mm ² | 15.6 |
| HM 05-T-50 | 365 | 264 | 110 | - | - | 254 | 120 | 10 | 10 | 4G1.0mm ² | 11.9 |
| HM 10-T-50 | 380 | 279 | 116 | - | - | 285 | 135 | 10 | 10 | 4G1.0mm ² | 14.1 |
| HM 10-T-80 | 380 | 279 | 116 | - | - | 285 | 135 | 10 | 10 | 4G1.0mm ² | 14.1 |



Model Code

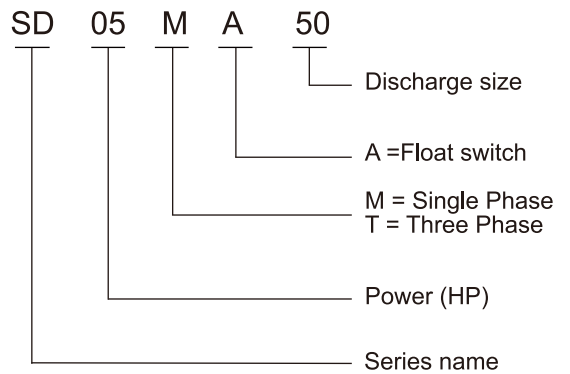

Applications

- Basement water removal
- Waste water drainage
- Water transfer
- Sump/effluent handling
- Dewatering
- Fish pond & fountain circulation
- Factory waste water handling

Motor Data

- Motor Type : 2 POLE , dry type
- Frequency : 60Hz
- Nominal Speed : 3450 rpm
- Insulation Class : F class (155°C)
- Enclosure Protection Class : IP 68
- Protection Device :
Thermal Protector (Single phase)
Overload Protector(Three phase)

Pump Data

- Impeller : Open Impeller
- Shaft Seal / Mechanical :
Double Seals
- Bearing :
Double-shielded Ball Bearing

Operation Conditions

- Fluid Temperature: 0 to 40°C (104°F)

Material

| NO. | Component | Material |
|-----|-----------------|---|
| 1 | Cable | H07RN-F |
| 2 | Handle | Nylon6+30GF(0.5~1.0HP) AISI304+NBR(2.0~5.0HP) SS41(7.5HP) |
| 3 | Motor cover | FC200 |
| 4 | Bearing cap | FC200 |
| 5 | Motor frame | AISI 304 |
| 6 | Bearing Bracket | FC200 |
| 7 | M.Seal Bracket | FC200 |
| 8 | Cable Base | Nylon6+30GF |
| 9 | Motor Shaft | AISI410 |
| 10 | Mechanical seal | CA/CE,SIC/SIC |
| 11 | Oil Seal | NBR 70 |
| 12 | Impeller | FC25 |
| 13 | Pump Casing | FC200 |
| 14 | Flange | FC200 |
| 15 | Strainer | AISI 304 |

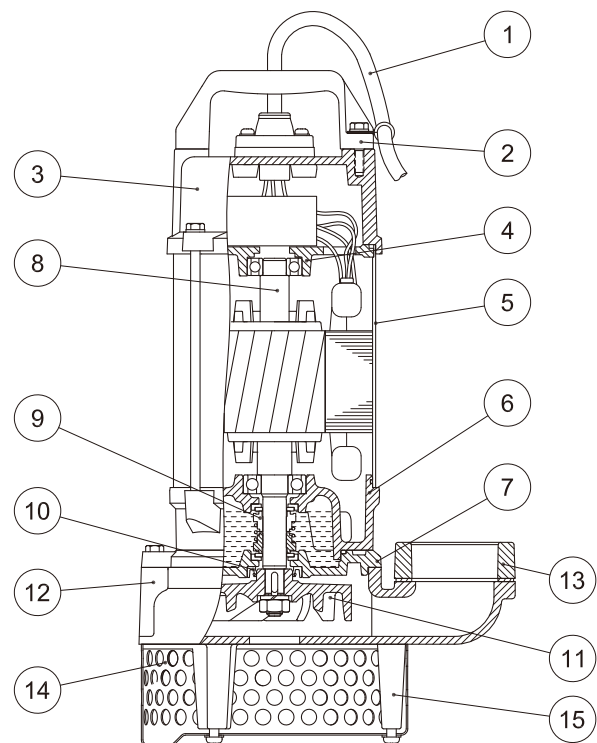

Performance Curves

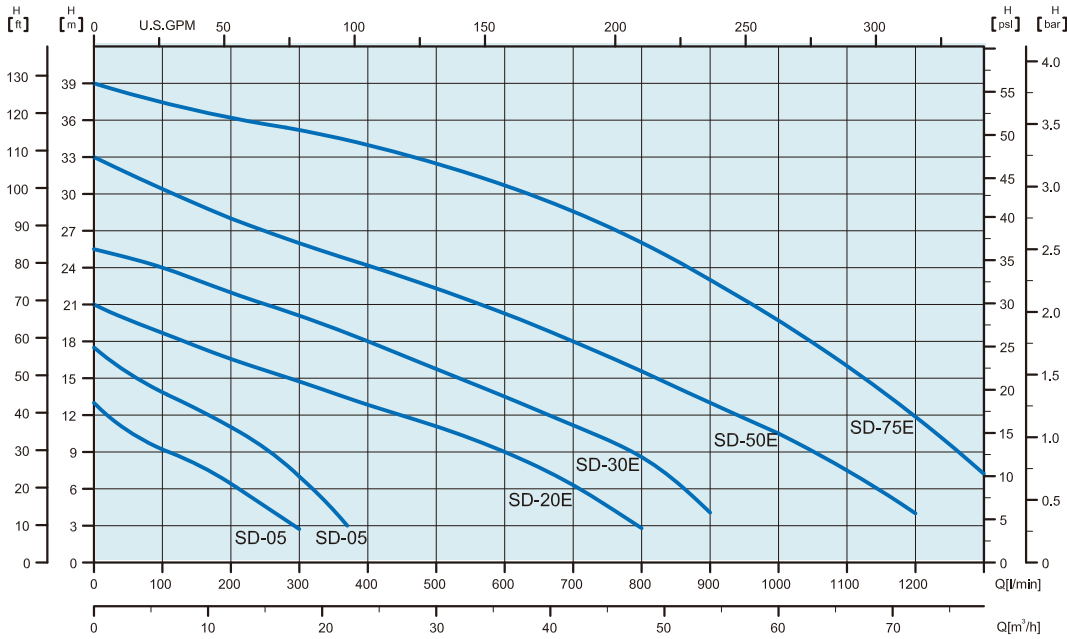

Technical Data

Single Phase

| Model | Power | | Current(A) | | Capacitoret | | Head | | Flow | | Discharge inch |
|--------------|-------|------|------------|----------|---------------------|--------------------|--------------|------------|------------------|----------------|-------------------|
| | HP | Kw | 110-127V | 220-230V | 110-127V U F / V | 220-230V UF / V | Rated (M) | Max (M) | Rated (L/min) | Max (L/min) | |
| SD 05-M-50 | 0.5 | 0.37 | 6.6-5.7 | 3.3-3.1 | 50uF 250V | 12uF 450V | 7.5 | 13.0 | 170 | 300 | 2" |
| SD 05-MA-50 | | | | | | | | | | | |
| SD 10-M-50 | 1.0 | 0.75 | 10.6-9.2 | 5.3-4.9 | 80uF 250V | 20uF 450V | 11.0 | 17.5 | 210 | 370 | 2" |
| SD 10-MA-50 | | | | | | | | | | | |
| SD 20E-M-50 | 2.0 | 1.5 | - | 10.0-9.2 | - | 40UF 450V | 11.5 | 21.0 | 480 | 800 | 2" |
| SD 20E-MA-50 | | | | | | | | | | | |
| SD 20E-M-80 | 2.0 | 1.5 | - | 10.0-9.2 | - | 40UF 450V | 11.5 | 21.0 | 480 | 800 | 3" |
| SD 20E-MA-80 | | | | | | | | | | | |

A = Auto Float Switch

Three Phase

| Model | Power | | Current(A) | | | Head | | Flow | | Discharge inch |
|--------------|-------|------|------------|-----------|----------|--------------|------------|------------------|----------------|-------------------|
| | HP | Kw | 220-230V | 380-440V | 460-480V | Rated (M) | Max (M) | Rated (L/min) | Max (L/min) | |
| SD 05-T-50 | 0.5 | 0.37 | 2.3-2.2 | 1.3-1.2 | 1.3-1.2 | 7.5 | 13.0 | 175 | 300 | 2" |
| SD 10-T-50 | 1.0 | 0.5 | 3.4-3.3 | 2.1-2.0 | 1.9-1.7 | 11.0 | 17.5 | 230 | 370 | 2" |
| SD 20E-T-50 | 2.0 | 1.5 | 6.3-6.0 | 3.6-3.4 | 3.2-3.0 | 11.5 | 21.0 | 475 | 810 | 2" |
| SD 20E-T-80 | 2.0 | 1.5 | 6.3-6.0 | 3.6-3.4 | 3.2-3.0 | 11.5 | 21.0 | 475 | 810 | 3" |
| SD 30E-T-50 | 3.0 | 2.2 | 8.8-8.5 | 5.0-4.8 | 4.8-4.7 | 14.0 | 25.7 | 580 | 940 | 2" |
| SD 30E-T-80 | 3.0 | 2.2 | 8.8-8.5 | 5.0-4.8 | 4.8-4.7 | 14.0 | 25.7 | 580 | 940 | 3" |
| SD 50E-T-80 | 5.0 | 3.7 | 13.6-13.0 | 8.0-7.8 | 7.5-7.3 | 21.0 | 33.2 | 590 | 1215 | 3" |
| SD 50E-T-100 | 5.0 | 3.7 | 13.6-13.0 | 8.0-7.8 | 7.5-7.3 | 21.0 | 33.2 | 590 | 1215 | 4" |
| SD 75E-T-80 | 7.5 | 5.5 | 20.0-18.5 | 12.0-11.0 | 10.5-9.5 | 29.0 | 39.0 | 680 | 1300 | 3" |
| SD 75E-T-100 | 7.5 | 5.5 | 20.0-18.5 | 12.0-11.0 | 10.5-9.5 | 29.0 | 39.0 | 680 | 1300 | 4" |

Dimensions

| Model | Discharge[mm] | | | | | | | | Solid Passage [mm] | Cable-10M | N.W. [kg] |
|--------------|---------------|-----|-----|-----|-----|-----|-----|-----|--------------------|----------------------|-----------|
| | H | H1 | H2 | H3 | A | B | C | D | | H07 RN-F | |
| SD 05-M-50 | 411 | 356 | 114 | 130 | 240 | 201 | – | 173 | 10 | 3G1.0mm ² | 16.0 |
| SD 05-MA-50 | 411 | 356 | 114 | 130 | 240 | 201 | – | 173 | 10 | 3G1.0mm ² | 16.5 |
| SD 10-M-50 | 431 | 376 | 114 | 130 | 240 | 201 | – | 173 | 10 | 3G1.0mm ² | 18.0 |
| SD 10-MA-50 | 431 | 376 | 114 | 130 | 240 | 201 | – | 173 | 10 | 3G1.0mm ² | 18.5 |
| SD 20E-M-50 | 546 | 480 | 133 | 227 | 398 | 343 | 253 | 220 | 10 | 3G1.5mm ² | 42.5 |
| SD 20E-MA-50 | 546 | 480 | 133 | 227 | 398 | 343 | 253 | 220 | 10 | 3G1.5mm ² | 43.0 |
| SD 20E-M-80 | 546 | 480 | 133 | 227 | 398 | 343 | 253 | 220 | 10 | 3G1.5mm ² | 42.5 |
| SD 20E-MA-80 | 546 | 480 | 133 | 227 | 398 | 343 | 253 | 220 | 10 | 3G1.5mm ² | 43.0 |
| SD 05-T-50 | 411 | 356 | 114 | 130 | 240 | 201 | – | 173 | 10 | 4G1.0mm ² | 15.0 |
| SD 10-T-50 | 431 | 376 | 114 | 130 | 240 | 201 | – | 173 | 10 | 4G1.0mm ² | 17.0 |
| SD 20E-T-50 | 506 | 441 | 133 | 227 | 398 | 343 | 255 | 220 | 10 | 4G1.5mm ² | 36.0 |
| SD 20E-T-80 | 506 | 441 | 133 | 227 | 398 | 343 | 255 | 220 | 10 | 4G1.5mm ² | 36.0 |
| SD 30E-T-50 | 506 | 441 | 133 | 227 | 398 | 343 | 255 | 220 | 10 | 4G1.5mm ² | 38.5 |
| SD 30E-T-80 | 506 | 441 | 133 | 227 | 398 | 343 | 255 | 220 | 10 | 4G1.5mm ² | 38.5 |
| SD 50E-T-80 | 526 | 461 | 133 | 265 | 430 | 337 | 255 | 220 | 10 | 4G2.5mm ² | 45.0 |
| SD 50E-T-100 | 526 | 461 | 133 | 265 | 430 | 337 | 255 | 220 | 10 | 4G2.5mm ² | 45.0 |
| SD 75E-T-80 | 658 | 553 | 133 | 265 | 474 | 380 | 294 | 230 | 10 | 4G2.5mm ² | 61.0 |
| SD 75E-T-100 | 658 | 553 | 133 | 265 | 474 | 380 | 294 | 230 | 10 | 4G2.5mm ² | 61.0 |

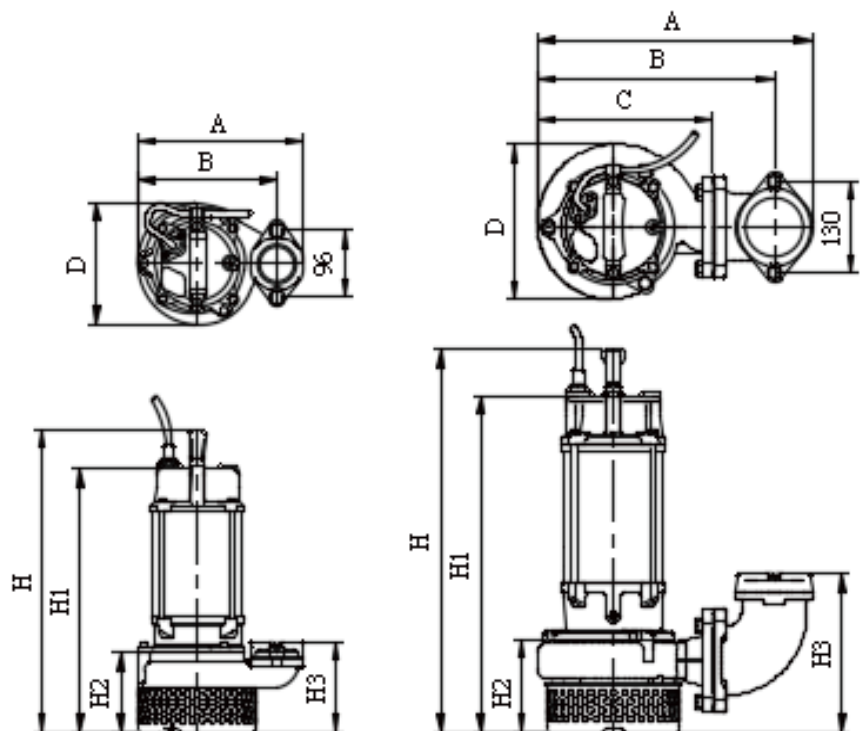



Model Code

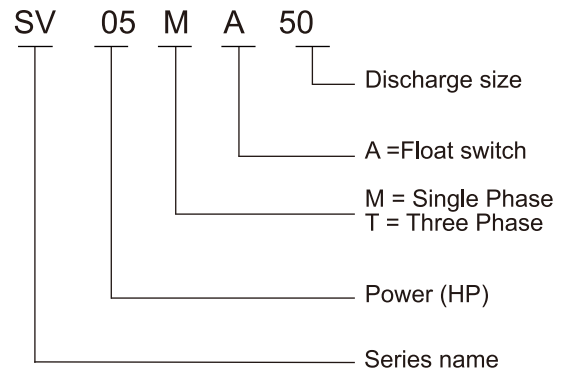

Applications

- Basement water removal
- Waste water drainage
- Water transfer
- Sump/effluent handling
- Dewatering
- Fish pond & fountain circulation
- Factory waste water handling

Motor Data

- Motor Type : 2 POLE , dry type
- Frequency : 60Hz
- Nominal Speed : 3450 rpm
- Insulation Class : F class (155°C)
- Enclosure Protection Class : IP 68
- Protection Device : Thermal Protector (Single phase) Overload Protector(Three phase)

Pump Data

- Impeller : Vortex Impeller
- Shaft Seal / Mechanical : Double Seals
- Bearing : Double-shielded Ball Bearing

Operation Conditions

- Fluid Temperature: 0 to 40°C (104°F)

Material

| NO. | Component | Material |
|-----|-----------------|---|
| 1 | Cable | H07RN-F |
| 2 | Handle | Nylon6+30GF(0.5~1.0HP) AISI304+NBR(2.0~5.0HP) SS41(7.5HP) |
| 3 | Motor cover | FC200 |
| 4 | Bearing cap | FC200 |
| 5 | Motor frame | AISI 304 |
| 6 | Bearing Bracket | FC200 |
| 7 | M.Seal Bracket | FC200 |
| 8 | Motor Shaft | AISI410 |
| 9 | Mechanical seal | CA / CE, SIC/SIC |
| 10 | Oil Seal | NBR70 |
| 11 | Impeller | FC250 |
| 12 | Pump casing | FC200 |
| 13 | Flange | FC200 |

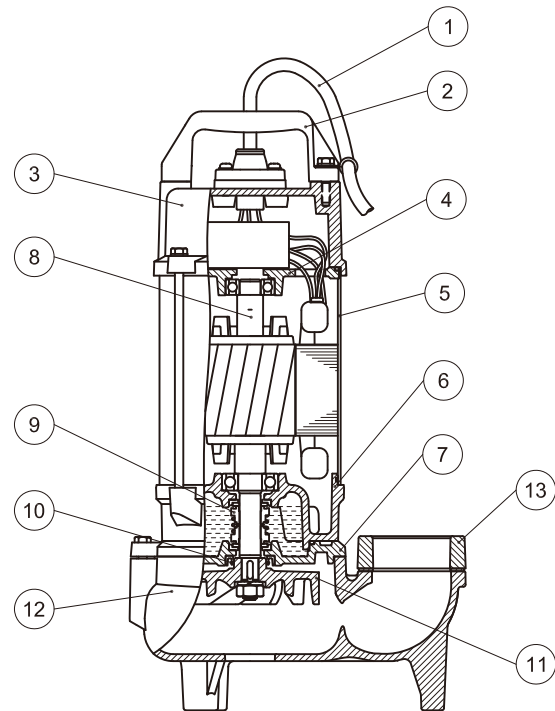

Submersible Vortex Sewage Pumps

60Hz

Performance Curves

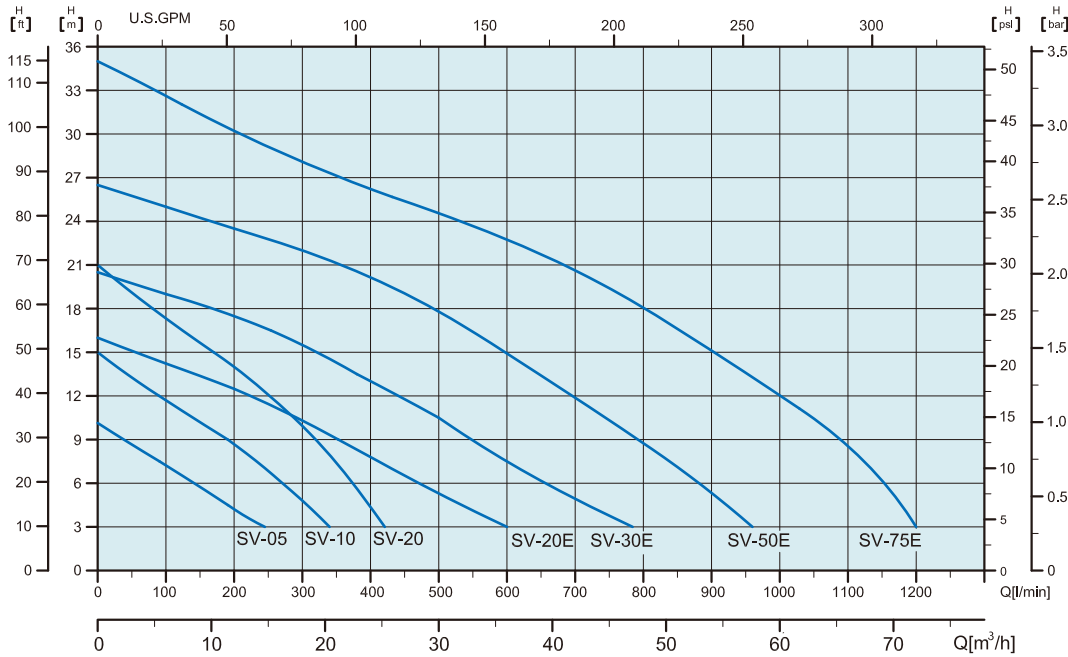

Technical Data

Single Phase

| Model | Power | | Current(A) | | Capacitoret | | Head | | Flow | | Discharge inch |
|--------------|--------------|------|------------|----------|-------------|-----------------|-----------------|-----------|---------|---------------|----------------|
| | Single Phase | HP | Kw | 110-127V | 220-230V | 110-127V UF / V | 220-230V UF / V | Rated (M) | Max (M) | Rated (L/min) | |
| SV 05-M-50 | 0.5 | 0.37 | 6.6-5.7 | 3.3-3.1 | 50uF 250V | 12uF 450V | 5.5 | 10.0 | 150 | 250 | 2" |
| SV 05-MA-50 | | | | | | | | | | | |
| SV 10-M-50 | 1.0 | 0.75 | 10.6-9.2 | 5.3-4.9 | 80uF 250V | 20uF 450V | 8.0 | 14.0 | 200 | 350 | 2" |
| SV 10-MA-50 | | | | | | | | | | | |
| SV 20-M-50 | 2.0 | 1.5 | - | 10.0-9.2 | - | 40UF 450V | 14.0 | 21.0 | 200 | 410 | 2" |
| SV 20-MA-50 | | | | | | | | | | | |
| SV 20E-M-50 | 2.0 | 1.5 | - | 10.0-9.2 | - | 40UF 450V | 8.5 | 16.0 | 400 | 640 | 2" |
| SV 20E-MA-50 | | | | | | | | | | | |
| SV 20E-M-80 | 2.0 | 1.5 | - | 10.0-9.2 | - | 40UF 450V | 8.5 | 16.0 | 400 | 640 | 3" |
| SV 20E-MA-80 | | | | | | | | | | | |

A = Auto Float Switch

Three Phase

| Model | Power | | Current(A) | | | Head | | Flow | | Discharge inch |
|--------------|--------------|------|------------|-----------|----------|----------|-----------|---------|---------------|----------------|
| | Single Phase | HP | Kw | 220-230V | 380-440V | 460-480V | Rated (M) | Max (M) | Rated (L/min) | |
| SV 05-T-50 | 0.5 | 0.37 | 2.3-2.2 | 1.3-1.2 | 1.3-1.2 | 5.5 | 10.0 | 150 | 250 | 2" |
| SV 10-T-50 | 1.0 | 0.5 | 3.4-3.3 | 2.1-2.0 | 1.9-1.7 | 8.0 | 14.0 | 200 | 350 | 2" |
| SV 20-T-50 | 2.0 | 1.5 | 6.3-6.0 | 3.6-3.4 | 3.2-3.0 | 14.0 | 21.0 | 200 | 410 | 2" |
| SV 20E-T-50 | 2.0 | 1.5 | 6.3-6.0 | 3.6-3.4 | 3.2-3.0 | 8.5 | 16.0 | 400 | 640 | 2" |
| SV 20E-T-80 | 2.0 | 1.5 | 6.3-6.0 | 3.6-3.4 | 3.2-3.0 | 8.5 | 16.0 | 400 | 640 | 3" |
| SV 30E-T-50 | 3.0 | 2.2 | 8.8-8.5 | 5.0-4.8 | 4.8-4.7 | 13.0 | 20.0 | 400 | 800 | 2" |
| SV 30E-T-80 | 3.0 | 2.2 | 8.8-8.5 | 5.0-4.8 | 4.8-4.7 | 13.0 | 20.0 | 400 | 800 | 3" |
| SV 50E-T-80 | 5.0 | 3.7 | 13.6-13.0 | 8.0-7.8 | 7.5-7.3 | 18.0 | 26.5 | 500 | 950 | 3" |
| SV 50E-T-100 | 5.0 | 3.7 | 13.6-13.0 | 8.0-7.8 | 7.5-7.3 | 18.0 | 26.5 | 500 | 950 | 4" |
| SV 75E-T-80 | 7.5 | 5.5 | 20.0-18.5 | 12.0-11.0 | 10.5-9.5 | 22.0 | 35.0 | 640 | 1200 | 3" |
| SV 75E-T-100 | 7.5 | 5.5 | 20.0-18.5 | 12.0-11.0 | 10.5-9.5 | 22.0 | 35.0 | 640 | 1200 | 4" |

Dimensions

| Model | Discharge[mm] | | | | | | | | Solid Passage [mm] | Cable-10M H07 RN-F | N.W. [kg] |
|--------------|---------------|-----|-----|-----|-----|-----|-----|-----|--------------------|----------------------|-----------|
| | H | H1 | H2 | H3 | A | B | C | D | | | |
| SV 05-M-50 | 406 | 352 | 110 | 124 | 240 | 201 | - | 153 | 35 | 3G1.0mm ² | 17.0 |
| SV 05-MA-50 | 406 | 352 | 110 | 124 | 240 | 201 | - | 153 | 35 | 3G1.0mm ² | 17.5 |
| SV 10-M-50 | 406 | 372 | 110 | 124 | 240 | 201 | - | 153 | 35 | 3G1.0mm ² | 18.5 |
| SV 10-MA-50 | 406 | 372 | 110 | 124 | 240 | 201 | - | 153 | 35 | 3G1.0mm ² | 19.0 |
| SV 20-M-50 | 520 | 454 | 100 | 112 | 279 | 240 | - | 186 | 35 | 3G1.5mm ² | 30.0 |
| SV 20-MA-50 | 520 | 454 | 100 | 112 | 279 | 240 | - | 186 | 35 | 3G1.5mm ² | 30.5 |
| SV 20E-M-50 | 526 | 496 | 141 | 205 | 395 | 340 | 252 | 186 | 50 | 3G1.5mm ² | 37.0 |
| SV 20E-MA-50 | 526 | 496 | 141 | 205 | 395 | 340 | 252 | 186 | 50 | 3G1.5mm ² | 37.5 |
| SV 20E-M-80 | 526 | 496 | 141 | 205 | 395 | 340 | 252 | 186 | 50 | 3G1.5mm ² | 37.0 |
| SV 20E-MA-80 | 526 | 496 | 141 | 205 | 395 | 340 | 252 | 186 | 50 | 3G1.5mm ² | 37.5 |
| SV 05-T-50 | 406 | 352 | 110 | 124 | 240 | 201 | - | 153 | 35 | 4G1.0mm ² | 16.0 |
| SV 10-T-50 | 426 | 372 | 110 | 124 | 240 | 201 | - | 153 | 35 | 4G1.0mm ² | 17.5 |
| SV 20-T-50 | 480 | 414 | 100 | 112 | 279 | 240 | - | 186 | 35 | 4G1.5mm ² | 27.0 |
| SV 20E-T-50 | 522 | 456 | 141 | 205 | 395 | 340 | 255 | 186 | 50 | 4G1.5mm ² | 34.0 |
| SV 20E-T-80 | 522 | 456 | 141 | 205 | 395 | 340 | 255 | 186 | 50 | 4G1.5mm ² | 34.0 |
| SV 30E-T-50 | 522 | 456 | 141 | 205 | 395 | 340 | 255 | 186 | 50 | 4G1.5mm ² | 36.5 |
| SV 30E-T-80 | 522 | 456 | 141 | 205 | 395 | 340 | 255 | 186 | 50 | 4G1.5mm ² | 36.5 |
| SV 50E-T-80 | 542 | 476 | 141 | 240 | 428 | 335 | 255 | 186 | 50 | 4G2.5mm ² | 40.5 |
| SV 50E-T-100 | 542 | 476 | 141 | 240 | 428 | 335 | 255 | 186 | 50 | 4G2.5mm ² | 40.5 |
| SV 75E-T-80 | 680 | 579 | 158 | 253 | 472 | 380 | 294 | 227 | 50 | 4G2.5mm ² | 61.0 |
| SV 75E-T-100 | 680 | 579 | 158 | 253 | 472 | 380 | 294 | 227 | 50 | 4G2.5mm ² | 61.0 |

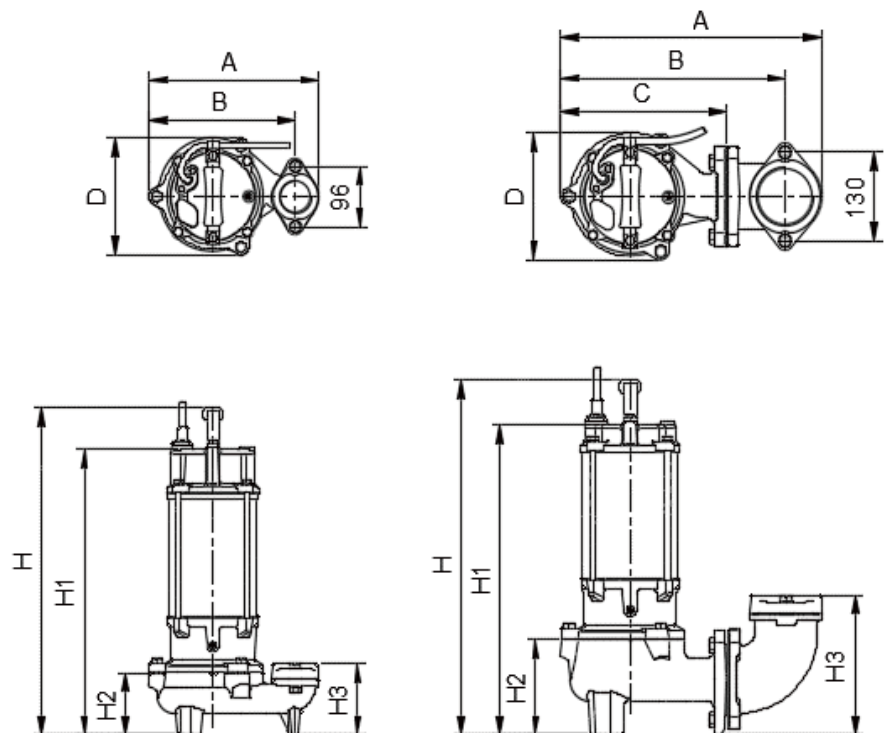



Model Code

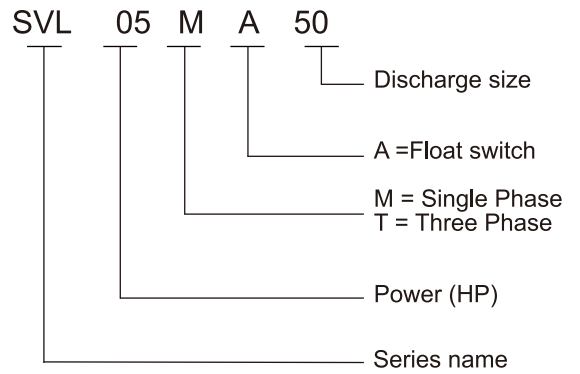

Applications

- Basement water removal
- Waste water drainage
- Water transfer
- Sump/effluent handling
- Dewatering
- Fish pond & fountain circulation
- Factory waste water handling

Motor Data

- Motor Type : 2 POLE , dry type
- Frequency : 60Hz
- Nominal Speed : 3450 rpm
- Insulation Class : F class (155°C)
- Enclosure Protection Class : IP 68
- Protection Device :
Thermal Protector (Single phase)
Overload Protector(Three phase)

Pump Data

- Impeller : Vortex Impeller
- Shaft Seal / Mechanical :
Double Seals
- Bearing :
Double-shielded Ball Bearing

Operation Conditions

- Fluid Temperature: 0 to 40°C (104°F)

Material

| NO. | Component | Material |
|-----|-----------------|------------------|
| 1 | Cable | H07RN-F |
| 2 | Handle | Nylon6+30GF |
| 3 | Motor cover | FC200 |
| 4 | Bearing cap | FC200 |
| 5 | Motor frame | AISI 304 |
| 6 | Bearing Bracket | FC200 |
| 7 | M.Seal Bracket | FC200 |
| 8 | Motor Shaft | AISI410 |
| 9 | Mechanical seal | CA / CE, SIC/SIC |
| 10 | Oil Seal | NBR70 |
| 11 | Impeller | FC250 |
| 12 | Pump casing | FC200 |
| 13 | Flange | FC200 |

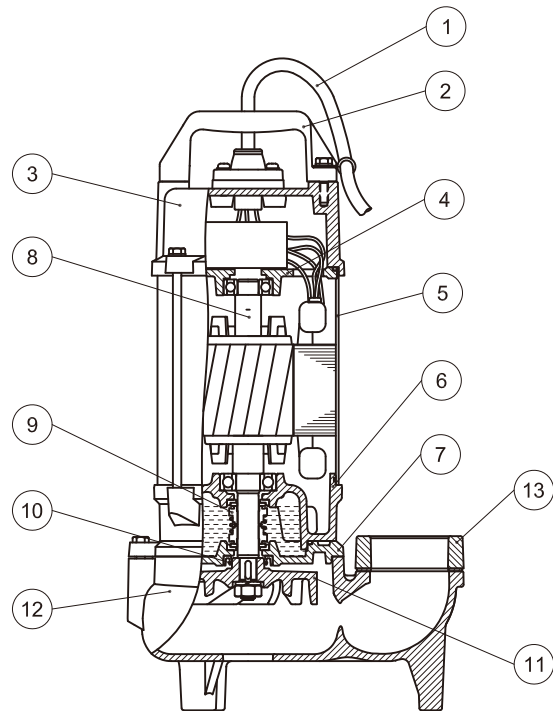

Performance Curves

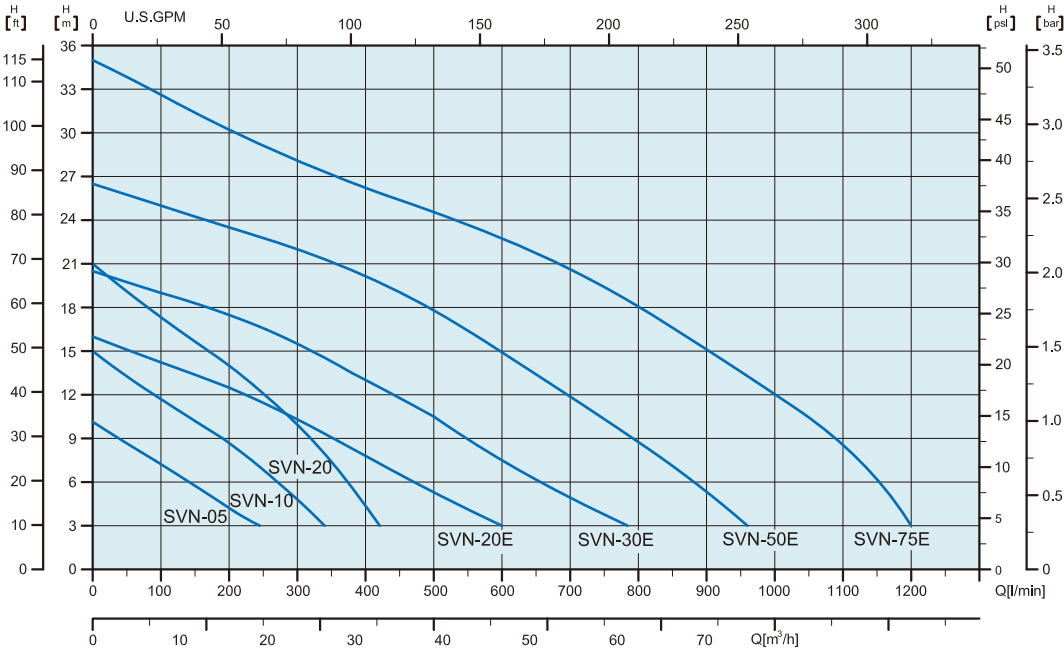

Technical Data

Single Phase

| Model | Power | | Current(A) | | Capacitoret | | Head | | Flow | | Discharge inch |
|--------------|-------|------|------------|----------|-----------------|---------------|-----------|---------|---------------|-------------|----------------|
| | HP | Kw | 110-127V | 220-230V | 110-127V UF / V | 220-230V UF/V | Rated (M) | Max (M) | Rated (L/min) | Max (L/min) | |
| SVL 05-M-50 | 0.5 | 0.37 | 6.6-5.7 | 3.3-3.1 | 50uF 250V | 12uF 450V | 4.0 | 7.0 | 200 | 300 | 2" |
| SVL 05-MA-50 | | | | | | | | | | | |
| SVL 10-M-50 | 1.0 | 0.75 | 10.6-9.2 | 5.3-4.9 | 80uF 250V | 20uF 450V | 6.0 | 11.0 | 250 | 400 | 2" |
| SVL 10-MA-50 | | | | | | | | | | | |
| SVL 05-M-80 | 0.5 | 0.37 | 6.6-5.7 | 3.3-3.1 | 50uF 250V | 12uF 450V | 4.0 | 7.0 | 200 | 300 | 3" |
| SVL 05-MA-80 | | | | | | | | | | | |
| SVL 10-M-80 | 1.0 | 0.75 | 10.6-9.2 | 5.3-4.9 | 80uF 250V | 20uF 450V | 6.0 | 11.0 | 250 | 400 | 3" |
| SVL 10-MA-80 | | | | | | | | | | | |

A = Auto Float Switch

Three Phase

| Model | Power | | Current(A) | | | Head | | Flow | | Discharge inch |
|-------------|-------|------|------------|----------|----------|-----------|---------|---------------|-------------|----------------|
| | HP | Kw | 220-230V | 380-440V | 460-480V | Rated (M) | Max (M) | Rated (L/min) | Max (L/min) | |
| SVL 05-T-50 | 0.5 | 0.37 | 2.3-2.2 | 1.3-1.2 | 1.3-1.2 | 4.0 | 7.0 | 200 | 300 | 2" |
| SVL 10-T-50 | 1.0 | 0.5 | 3.4-3.3 | 2.1-2.0 | 1.9-1.7 | 6.0 | 11.0 | 250 | 400 | 2" |
| SVL 05-T-80 | 0.5 | 0.37 | 2.3-2.2 | 1.3-1.2 | 1.3-1.2 | 4.0 | 7.0 | 200 | 300 | 3" |
| SVL 10-T-80 | 1.0 | 0.5 | 3.4-3.3 | 2.1-2.0 | 1.9-1.7 | 6.0 | 11.0 | 250 | 400 | 3" |

Dimensions

| Model | Discharge[mm] | | | | | | | | Solid Passage [mm] | Cable-10M | N.W. |
|--------------|---------------|-----|-----|-----|-----|-----|---|-----|--------------------|----------------------|------|
| | H | H1 | H2 | H3 | A | B | C | D | | H07 RN-F | [kg] |
| SVL 05-M-50 | 437 | 383 | 141 | 143 | 247 | 208 | - | 166 | 50 | 3G1.0mm ² | 19.0 |
| SVL 05-MA-50 | 437 | 383 | 141 | 143 | 247 | 208 | - | 166 | 50 | 3G1.0mm ² | 19.5 |
| SVL 10-M-50 | 457 | 403 | 141 | 143 | 247 | 208 | - | 166 | 50 | 3G1.0mm ² | 20.7 |
| SVL 10-MA-50 | 457 | 403 | 141 | 143 | 247 | 208 | - | 166 | 50 | 3G1.0mm ² | 21.2 |
| SVL 05-M-80 | 437 | 383 | 141 | 143 | 283 | 227 | - | 166 | 50 | 3G1.5mm ² | 19.0 |
| SVL 05-MA-80 | 437 | 383 | 141 | 143 | 283 | 227 | - | 166 | 50 | 3G1.5mm ² | 19.5 |
| SVL 10-M-80 | 457 | 403 | 141 | 143 | 283 | 227 | - | 166 | 50 | 3G1.5mm ² | 20.7 |
| SVL 10-MA-80 | 457 | 403 | 141 | 143 | 283 | 227 | - | 166 | 50 | 3G1.5mm ² | 21.2 |
| SVL 05-T-50 | 437 | 383 | 141 | 143 | 247 | 208 | - | 166 | 50 | 3G1.5mm ² | 18.0 |
| SVL 10-T-50 | 457 | 403 | 141 | 143 | 247 | 208 | - | 166 | 50 | 3G1.5mm ² | 19.5 |
| SVL 05-T-80 | 437 | 383 | 141 | 143 | 283 | 227 | - | 166 | 50 | 4G1.0mm ² | 18.0 |
| SVL 10-T-80 | 457 | 403 | 141 | 143 | 283 | 227 | - | 166 | 50 | 4G1.0mm ² | 19.5 |

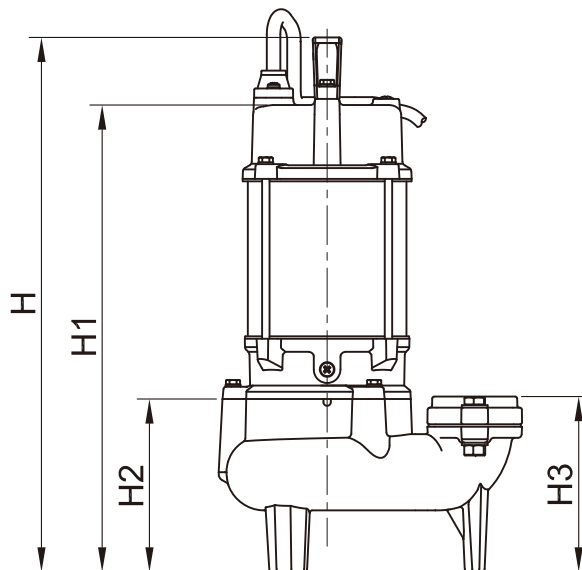
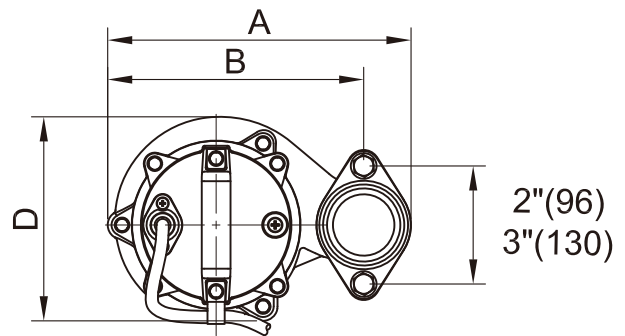



Model Code

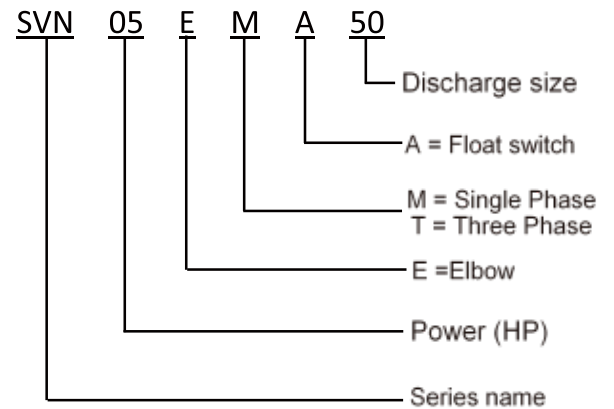

Applications

- Basement water removal
- Waste water drainage
- Water transfer
- Sump/effluent handling
- Dewatering
- Fish pond & fountain circulation
- Factory waste water handling

Motor Data

- Motor Type : 2 POLE , dry type
- Frequency : 60Hz
- Nominal Speed : 3450 rpm
- Insulation Class : F class (155°C)
- Enclosure Protection Class : IP 68
- Protection Device :
Thermal Protector (Single phase)
Overload Protector(Three phase)

Pump Data

- Impeller : Vortex Impeller
- Shaft Seal / Mechanical :
Double Seals
- Bearing :
Double-shielded Ball Bearing

Operation Conditions

- Fluid Temperature: 0 to 40°C (104°F)

Material

| No. | Component | Material |
|-----|-----------------|----------------------------|
| 1 | Cable | H07RN-F |
| 2 | Handle | Nylon6+30GF AISI304+NBR |
| 3 | Motor cover | CF8M |
| 4 | Bearing cap | FC200 |
| 5 | Motor frame | AISI 304 |
| 6 | Bearing Bracket | CF8M |
| 7 | M.Seal Bracket | CF8M |
| 8 | Motor Shaft | AISI410 |
| 9 | Mechanical seal | CA / CE, SIC/SIC |
| 10 | Oil Seal | VITON70 |
| 11 | Impeller | CF8M |
| 12 | Pump casing | CF8M |
| 13 | Flange | CF8M |

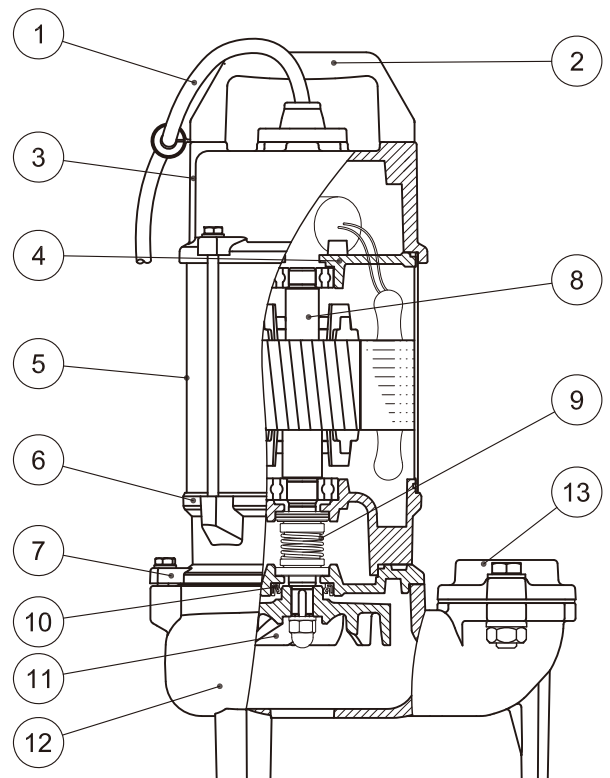

Submersible Vortex Sewage Pumps

60Hz

Performance Curves

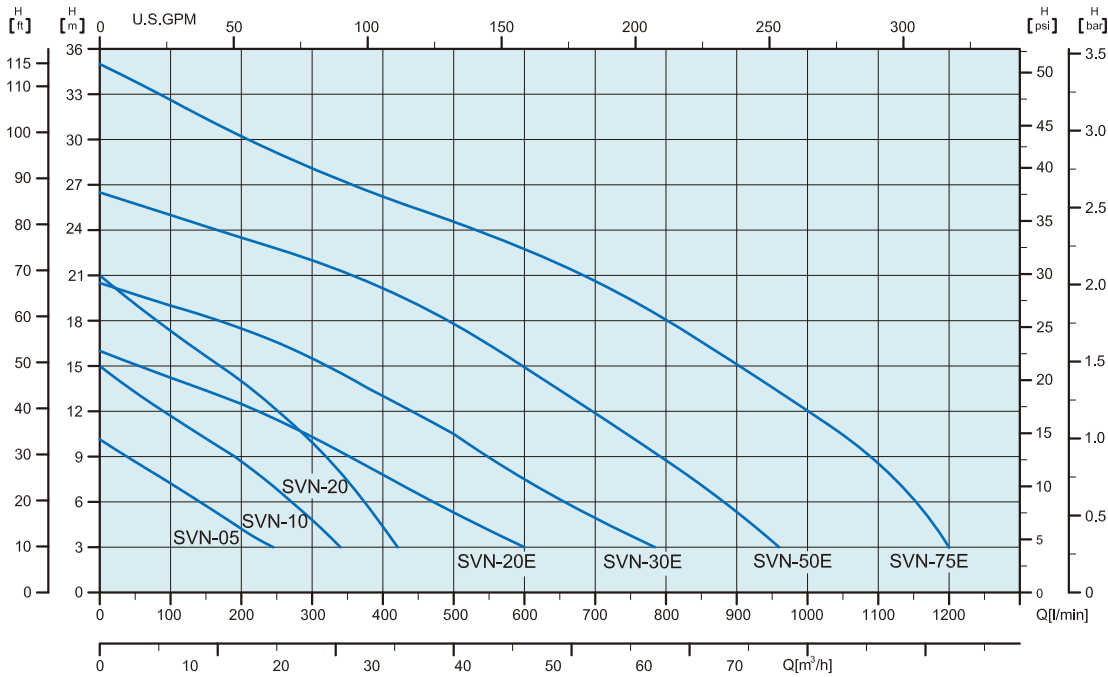

Technical Data

Single Phase

| Model | Power | | Current(A) | | Capacitoret | | Head | | Flow | | Discharge inch |
|---------------|-------|------|------------|----------|--------------------|--------------------|-----------|---------|---------------|-------------|----------------|
| | HP | Kw | 110-127V | 220-230V | 110-127V UF / V | 220-230V UF / V | Rated (M) | Max (M) | Rated (L/min) | Max (L/min) | |
| SVN 05-M-50 | 0.5 | 0.37 | 6.6-5.7 | 3.3-3.1 | 50uF 250V | 12uF 450V | 5.5 | 10.0 | 150 | 250 | 2" |
| SVN 05-MA-50 | | | | | | | | | | | |
| SVN 10-M-50 | 1.0 | 0.75 | 10.6-9.2 | 5.3-4.9 | 80uF 250V | 20uF 450V | 8.0 | 12.0 | 200 | 350 | 2" |
| SVN 10-MA-50 | | | | | | | | | | | |
| SVN 20-M-50 | 2.0 | 1.5 | - | 10.0-9.2 | - | 40UF 450V | 14.0 | 21.0 | 200 | 410 | 2" |
| SVN 20-MA-50 | | | | | | | | | | | |
| SVN 20E-M-50 | 2.0 | 1.5 | - | 10.0-9.2 | - | 40UF 450V | 8.5 | 16.0 | 400 | 640 | 2" |
| SVN 20E-MA-50 | | | | | | | | | | | |
| SVN 20E-M-80 | 2.0 | 1.5 | - | 10.0-9.2 | - | 40UF 450V | 8.5 | 16.0 | 400 | 640 | 3" |
| SVN 20E-MA-80 | | | | | | | | | | | |

Three Phase

| Model | Power | | Current(A) | | | Head | | Flow | | Discharge inch |
|---------------|-------|------|------------|-----------|----------|-----------|---------|---------------|-------------|----------------|
| | HP | Kw | 220-230V | 380-440V | 460-480V | Rated (M) | Max (M) | Rated (L/min) | Max (L/min) | |
| SVN 05-T-50 | 0.5 | 0.37 | 2.3-2.2 | 1.3-1.2 | 1.3-1.2 | 5.5 | 10.0 | 150 | 250 | 2" |
| SVN 10-T-50 | 1.0 | 0.5 | 3.4-3.3 | 2.1-2.0 | 1.9-1.7 | 8.0 | 12.0 | 200 | 350 | 2" |
| SVN 20-T-50 | 2.0 | 1.5 | 6.3-6.0 | 3.6-3.4 | 3.2-3.0 | 14.0 | 21.0 | 200 | 410 | 2" |
| SVN 20E-T-50 | 2.0 | 1.5 | 6.3-6.0 | 3.6-3.4 | 3.2-3.0 | 8.5 | 16.0 | 400 | 640 | 2" |
| SVN 20E-T-80 | 2.0 | 1.5 | 6.3-6.0 | 3.6-3.4 | 3.2-3.0 | 8.5 | 16.0 | 400 | 640 | 3" |
| SVN 30E-T-50 | 3.0 | 2.2 | 8.8-8.5 | 5.0-4.8 | 4.8-4.7 | 12.0 | 20.0 | 400 | 800 | 2" |
| SVN 30E-T-80 | 3.0 | 2.2 | 8.8-8.5 | 5.0-4.8 | 4.8-4.7 | 12.0 | 20.0 | 400 | 800 | 3" |
| SVN 50E-T-80 | 5.0 | 3.7 | 13.6-13.0 | 8.0-7.8 | 7.5-7.3 | 18.0 | 26.5 | 500 | 950 | 3" |
| SVN 50E-T-100 | 5.0 | 3.7 | 13.6-13.0 | 8.0-7.8 | 7.5-7.3 | 18.0 | 26.5 | 500 | 950 | 4" |
| SVN 75E-T-80 | 7.5 | 5.5 | 20.0-18.5 | 12.0-11.0 | 10.5-9.5 | 22.0 | 35.0 | 640 | 1200 | 3" |
| SVN 75E-T-100 | 7.5 | 5.5 | 20.0-18.5 | 12.0-11.0 | 10.5-9.5 | 22.0 | 35.0 | 640 | 1200 | 4" |

Dimensions

| Model | Discharge[mm] | | | | | | | | Solid Passage [mm] | Cable-10M H07 RN-F | N.W. [kg] |
|---------------|---------------|-----|-----|-----|-----|-----|-----|-----|--------------------|-----------------------|--------------|
| | H | H1 | H2 | H3 | A | B | C | D | | | |
| SVN 05-M-50 | 406 | 352 | 110 | 124 | 240 | 201 | – | 153 | 35 | 3G1.0mm ² | 15.5 |
| SVN 05-MA-50 | 406 | 352 | 110 | 124 | 240 | 201 | – | 153 | 35 | 3G1.0mm ² | 16.0 |
| SVN 10-M-50 | 406 | 372 | 110 | 124 | 240 | 201 | – | 153 | 35 | 3G1.0mm ² | 17.0 |
| SVN 10-MA-50 | 406 | 372 | 110 | 124 | 240 | 201 | – | 153 | 35 | 3G1.0mm ² | 17.5 |
| SVN 20-M-50 | 520 | 454 | 100 | 112 | 279 | 240 | – | 186 | 35 | 3G1.5mm ² | 28.0 |
| SVN 20-MA-50 | 520 | 454 | 100 | 112 | 279 | 240 | – | 186 | 35 | 3G1.5mm ² | 28.5 |
| SVN 20E-M-50 | 526 | 496 | 141 | 205 | 395 | 340 | 252 | 186 | 50 | 3G1.5mm ² | 34.0 |
| SVN 20E-MA-50 | 526 | 496 | 141 | 205 | 395 | 340 | 252 | 186 | 50 | 3G1.5mm ² | 34.5 |
| SVN 20E-M-80 | 526 | 496 | 141 | 205 | 395 | 340 | 252 | 186 | 50 | 3G1.5mm ² | 34.0 |
| SVN 20E-MA-80 | 526 | 496 | 141 | 205 | 395 | 340 | 252 | 186 | 50 | 3G1.5mm ² | 34.5 |
| SVN 05-T-50 | 406 | 352 | 110 | 124 | 240 | 201 | – | 153 | 35 | 4G1.0mm ² | 13.0 |
| SVN 10-T-50 | 426 | 372 | 110 | 124 | 240 | 201 | – | 153 | 35 | 4G1.0mm ² | 14.5 |
| SVN 20-T-50 | 480 | 414 | 100 | 112 | 279 | 240 | – | 186 | 35 | 4G1.5mm ² | 25.5 |
| SVN 20E-T-50 | 522 | 456 | 141 | 205 | 395 | 340 | 255 | 186 | 50 | 4G1.5mm ² | 32.0 |
| SVN 20E-T-80 | 522 | 456 | 141 | 205 | 395 | 340 | 255 | 186 | 50 | 4G1.5mm ² | 32.0 |
| SVN 30E-T-50 | 522 | 456 | 141 | 205 | 395 | 340 | 255 | 186 | 50 | 4G1.5mm ² | 34.0 |
| SVN 30E-T-80 | 522 | 456 | 141 | 205 | 395 | 340 | 255 | 186 | 50 | 4G1.5mm ² | 34.0 |
| SVN 50E-T-80 | 542 | 476 | 141 | 240 | 428 | 335 | 255 | 186 | 50 | 4G2.5mm ² | 41.0 |
| SVN 50E-T-100 | 542 | 476 | 141 | 240 | 428 | 335 | 255 | 186 | 50 | 4G2.5mm ² | 41.0 |
| SVN 75E-T-80 | 680 | 579 | 158 | 253 | 472 | 380 | 294 | 227 | 50 | 4G2.5mm ² | 57.0 |
| SVN 75E-T-100 | 680 | 579 | 158 | 253 | 472 | 380 | 294 | 227 | 50 | 4G2.5mm ² | 57.0 |

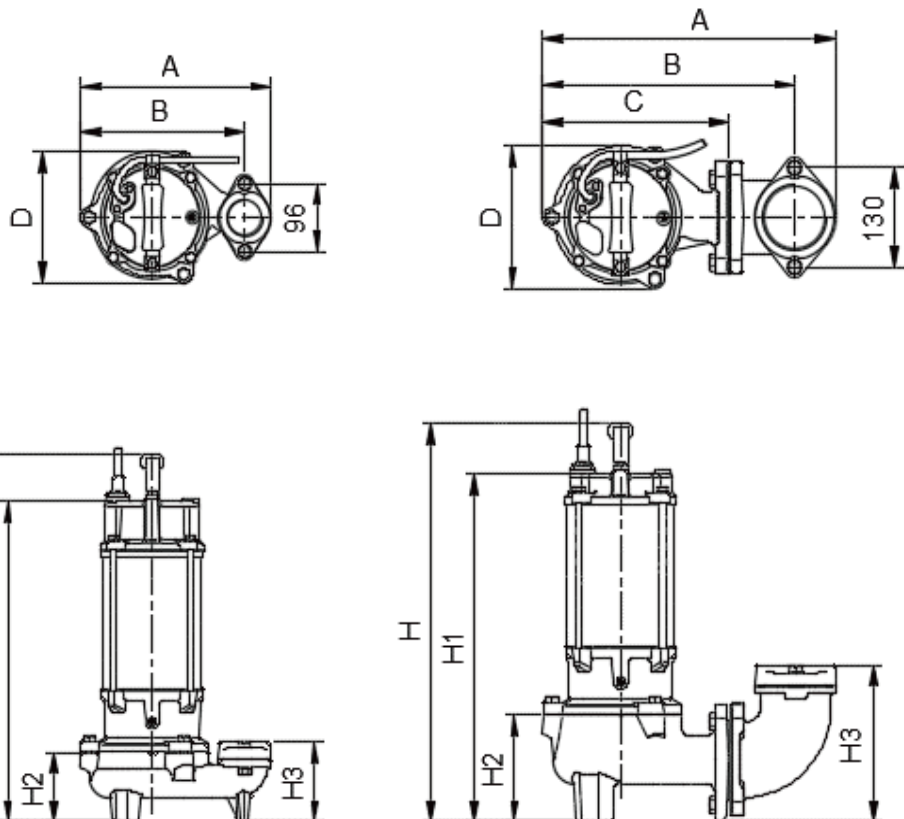

TS-50

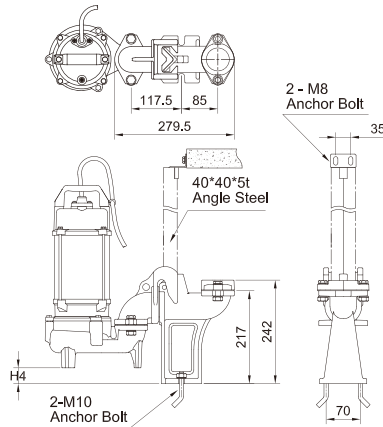

| Model | TS-50 Guide Rail | |
|-----------|------------------|-------------------|
| | DN (mm) | Dimensions H4(mm) |
| SD-05-50 | 50 | 31 |
| SD-10-50 | 50 | 31 |
| SV-05-50 | 50 | 37 |
| SV-10-50 | 50 | 37 |
| SV-20-50 | 50 | 45 |
| SVL-05-50 | 50 | 15 |
| SVL-10-50 | 50 | 15 |
| HM-05-50 | 50 | 48 |

TSL-50/80

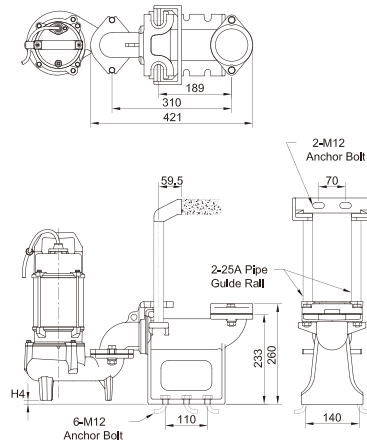

| Model | TSL-50/80 Guide Rail | |
|-----------|----------------------|-------------------|
| | DN (mm) | Dimensions H4(mm) |
| SVL-05-80 | 80 | 10 |
| SVL-10-80 | 80 | 10 |
| HM-10-50 | 50 | 43 |
| HM-10-80 | 80 | 43 |

TM-50/80

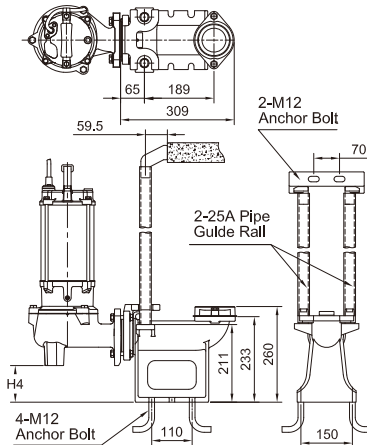

| Model | TM-50/80 Guide Rail | |
|-----------|---------------------|-------------------|
| | DN (mm) | Dimensions H4(mm) |
| SD-20E-50 | 50 | 77.5 |
| SD-20E-80 | 80 | 77.5 |
| SD-30E-50 | 50 | 77.5 |
| SD-30E-80 | 80 | 77.5 |
| SV-20E-50 | 50 | 99.5 |
| SV-20E-80 | 80 | 99.5 |
| SV-30E-50 | 50 | 99.5 |
| SV-30E-80 | 80 | 99.5 |

TL-80/100

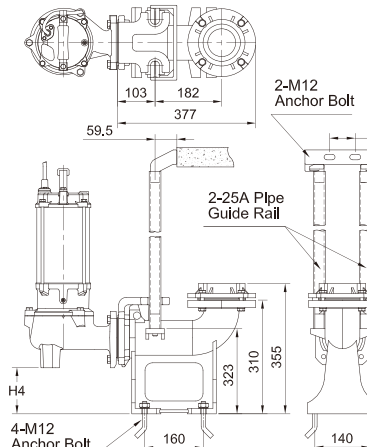

| Model | TL-80/100 Guide Rail | |
|------------|----------------------|-------------------|
| | DN (mm) | Dimensions H4(mm) |
| SD-50E-80 | 80 | 104.5 |
| SD-50E-100 | 100 | 104.5 |
| SD-75E-80 | 80 | 104.5 |
| SD-75E-100 | 100 | 104.5 |
| SV-50E-80 | 80 | 126.5 |
| SV-50E-100 | 100 | 126.5 |
| SV-75E-80 | 80 | 126.5 |
| SV-75E-100 | 100 | 126.5 |

STS-50

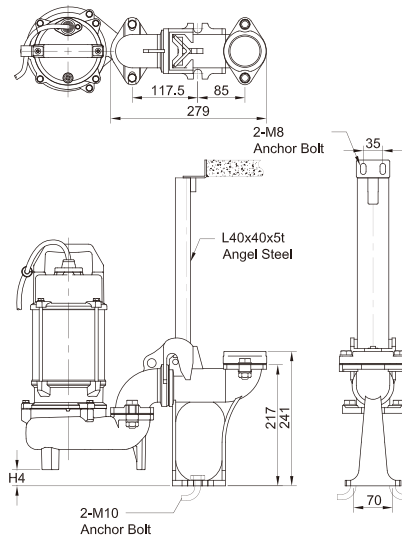

| Model | STS-50 Guide Rail | |
|-----------|-------------------|-------------------|
| | DN (mm) | Dimensions H4(mm) |
| SVN-05-50 | 50 | 29 |
| SVN-10-50 | 50 | 29 |
| SVN-20-50 | 50 | 40 |

STM-50/80

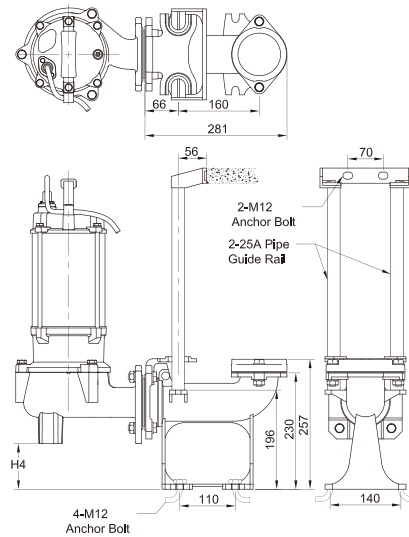

| Model | STM-50/80 Guide Rail | |
|------------|----------------------|-------------------|
| | DN (mm) | Dimensions H4(mm) |
| SVN-20E-50 | 50 | 90 |
| SVN-20E-80 | 80 | 90 |
| SVN-30E-50 | 50 | 90 |
| SVN-30E-80 | 80 | 90 |

STL-80/100

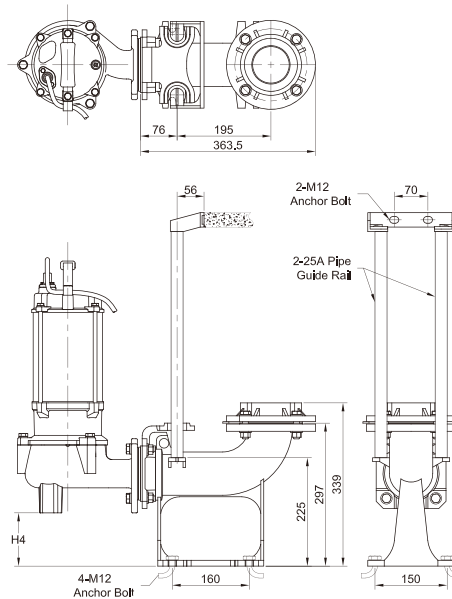

| Model | STL-80/100 Guide Rail | |
|-------------|-----------------------|-------------------|
| | DN (mm) | Dimensions H4(mm) |
| SVN-50E-80 | 80 | 110.5 |
| SVN-50E-100 | 100 | 110.5 |
| SVN-75E-80 | 80 | 104 |
| SVN-75E-100 | 100 | 104 |



Model Code

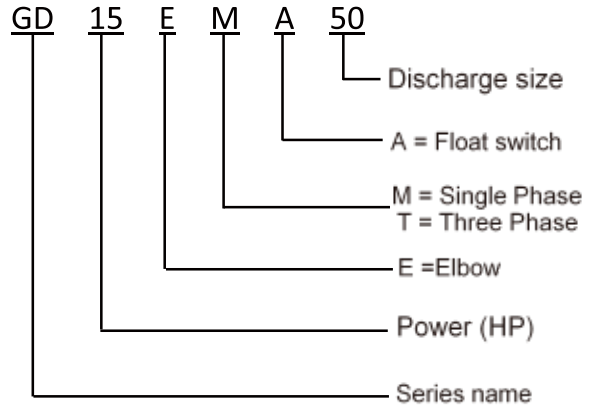

Applications

- General household use, Drainage systems for Buildings, Apartments, Resorts and Wastewater systems.
- Materials such as leather, textile fibres, food and other tougher objects can be pumped.
- Wastewater systems for Domestic, Commercial, Industrial, Municipal, Schools, Hospitals and many other uses.
- Sewage and Drainage systems.

Advantages

- Robust construction.
- Superior Heat Dissipation.
- Macerating Impellor for cutting up materials.
- Double mechanical seals Upper : CA/CE Lower : SIC/SIC

Material

| NO. | Component | Material |
|-----|-----------------|------------------|
| 1 | Cable | H07RN-F |
| 2 | Handle | AISI304+NBR |
| 3 | Motor cover | FC200 |
| 4 | Bearing cap | FC200 |
| 5 | Motor frame | FC200 |
| 6 | Bearing Bracket | FC200 |
| 7 | M.Seal Bracket | FC200 |
| 8 | Motor Shaft | AISI 410 |
| 9 | Mechanical seal | CA / CE, SIC/SIC |
| 10 | Oil Seal | NBR70 |
| 11 | Impeller | FC250 |
| 12 | Pump casing | FC200 |
| 13 | Radidl cutter | AISI 440C |
| 14 | Cutter ring | AISI 440C |
| 15 | Flange | FC200 |

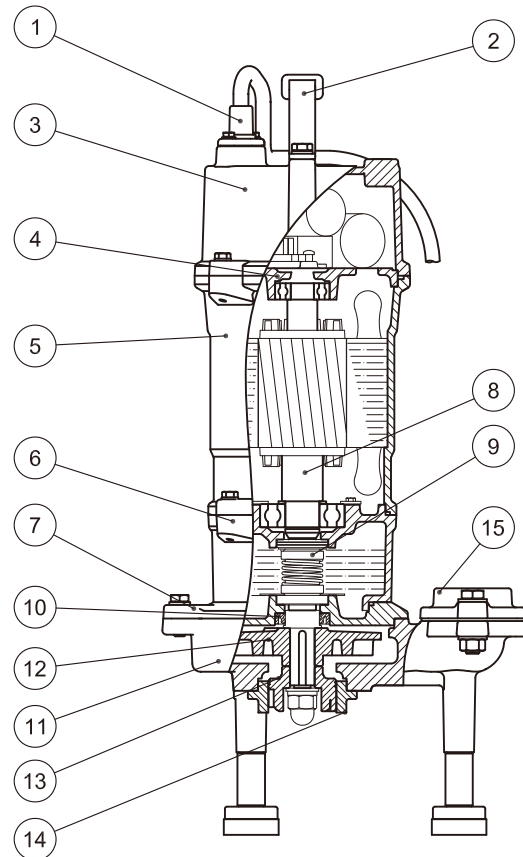

Submersible Grinder Pumps

60Hz

Performance Curves

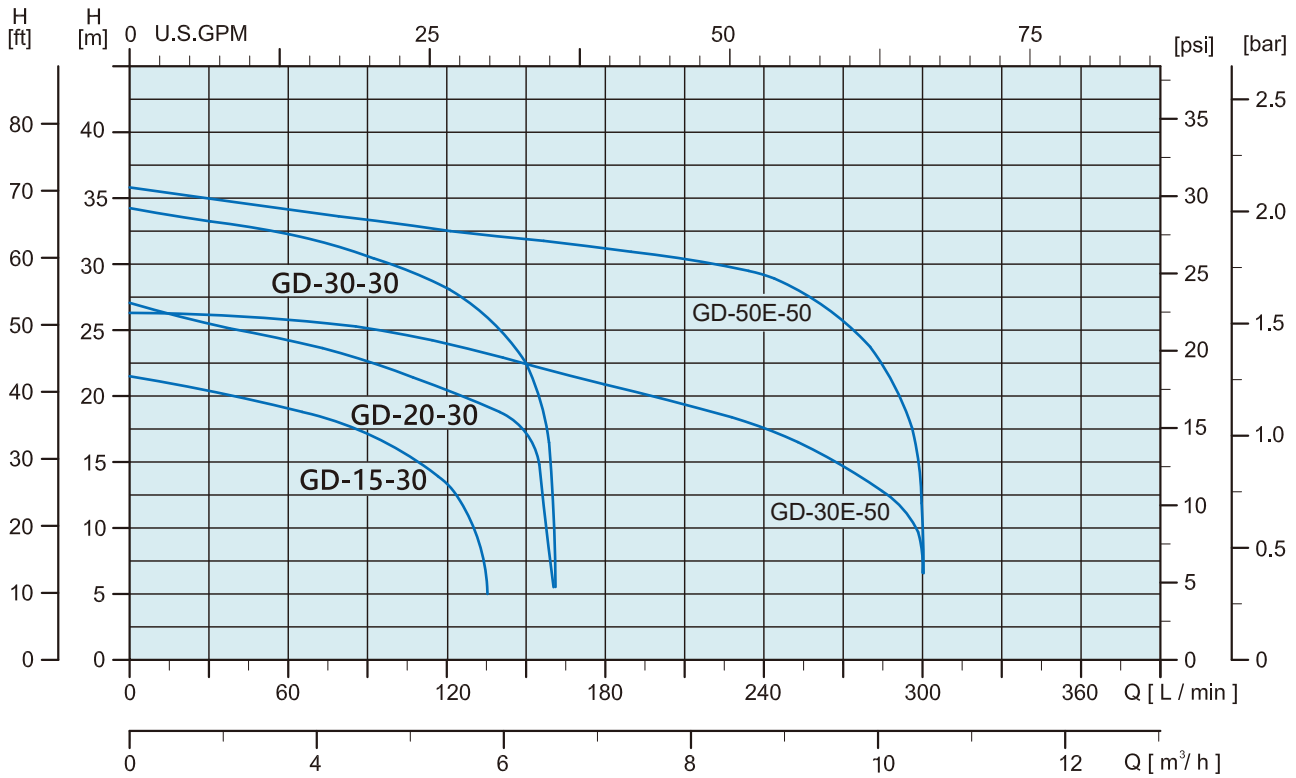

Technical Data

Single Phase

| Model | Power | | Current(A) | Discharge | Head | | Flow | | Cable | Weight |
|-------------|-------|-----|-------------|-----------|-----------|---------|---------------|-------------|-------|--------|
| | HP | Kw | | | Rated (M) | Max (M) | Rated (L/min) | Max (L/min) | | |
| GD 15-M-30 | 1.3 | 1.0 | 6.6 - 6.3 | 1 1/4" | 16.0 | 21.0 | 60 | 140 | 10 | 27.0 |
| GD 15-MA-30 | | | | | | | | | | 27.5 |
| GD 20-M-30 | 2.0 | 1.5 | 10.6 - 10.2 | 1 1/4" | 24.0 | 26.0 | 60 | 160 | 10 | 37.5 |
| GD 20-MA-30 | | | | | | | | | | 38.0 |

* A = Auto Float Switch

Three Phase

| Model | Power | | Current(A) | | | Discharge | Head | | Flow | | Cable | Weight |
|-------------|-------|-----|------------|----------|----------|-----------|-----------|---------|---------------|-------------|-------|--------|
| | HP | Kw | 220-230V | 380-440V | 460-480V | | Rated (M) | Max (M) | Rated (L/min) | Max (L/min) | | |
| GD 15-T-30 | 1.3 | 1.0 | 4.2-4.0 | 2.4-2.0 | 1.9-1.8 | 1 1/4" | 16.0 | 21.0 | 60 | 140 | 10 | 25 |
| GD 20-T-30 | 2.0 | 1.5 | 5.7-5.5 | 2.3-2.0 | 2.8-2.7 | 1 1/4" | 24.0 | 26.0 | 60 | 160 | 10 | 32 |
| GD 30-T-30 | 3.0 | 2.2 | 8.6-8.2 | 5.0-4.3 | 4.1-3.9 | 1 1/4" | 30.5 | 34.0 | 60 | 160 | 10 | 37 |
| GD 30E-T-50 | 3.0 | 2.2 | 9.7-9.3 | 5.2-4.5 | 4.3-4.2 | 2" | 21.0 | 26.0 | 200 | 300 | 10 | 52 |
| GD 50E-T-50 | 5.0 | 3.7 | 13.5-13.0 | 7.8-7.0 | 6.8-6.7 | 2" | 32.0 | 38.0 | 200 | 300 | 10 | 55 |

Dimensions

| Model | Phase | Discharge[mm] | | | | | | DN (mm) |
|-----------|-------|---------------|-----|-----|-----|-----|-----|---------|
| | | A | A1 | D | H | H1 | H2 | |
| GD-15-30 | 1 | 267 | 228 | 96 | 558 | 491 | 159 | 32 |
| | 3 | | | | 528 | 461 | 159 | |
| GD-20-30 | 1 | 290 | 251 | 96 | 605 | 538 | 159 | 32 |
| | 3 | | | | 550 | 483 | 159 | |
| GD-30-30 | 3 | 290 | 251 | 96 | 550 | 483 | 159 | 32 |
| GD-30E-50 | 3 | 428 | 268 | 215 | 569 | 502 | 237 | 50 |
| GD-50E-50 | 3 | 428 | 268 | 215 | 589 | 522 | 237 | 50 |

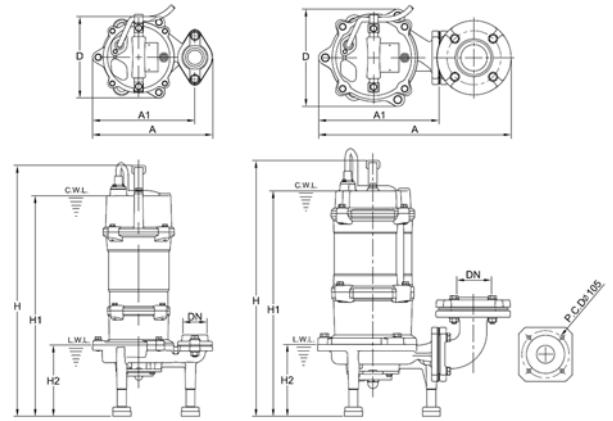

Guide Rail System

TS-32

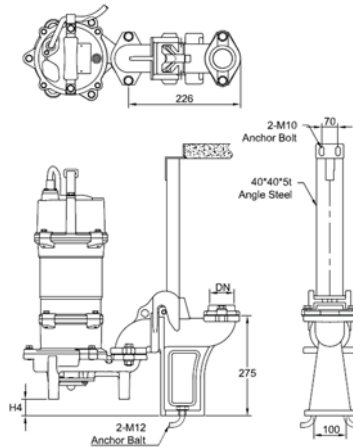
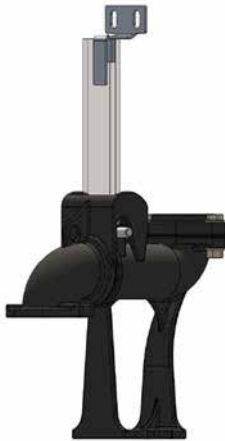

| Model | TS-32 Guide Rail | |
|----------|------------------|--------------------|
| | DN (mm) | Dimensions H4 (mm) |
| GD-15-30 | 32 | 36 |
| GD-20-30 | 32 | 34 |
| GD-30-30 | 32 | 34 |

TG-50

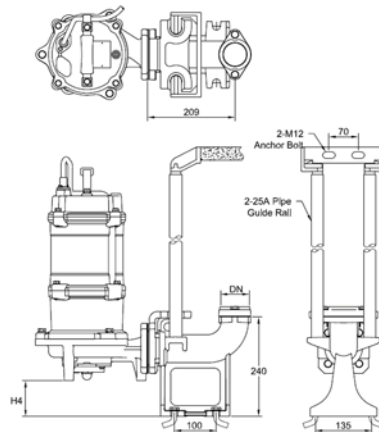

| Model | TG-50 Guide Rail | |
|-----------|------------------|--------------------|
| | DN (mm) | Dimensions H4 (mm) |
| GD-30E-50 | 50 | 88 |
| GD-50E-50 | 50 | 88 |



No. 3-8, Sanchial Tsun, Lutsao Hsiang, Chiayi County, Taiwan
Tel : +886 5 3750488 Fax: +886 5 3752330
www.stairs.com.tw E-mail: stairs@stairs.com.tw

1130821