

 STAIRS

XV series

60Hz

Submersible Drainage Pumps



STAIRS INDUSTRIAL CO., LTD.



Model code

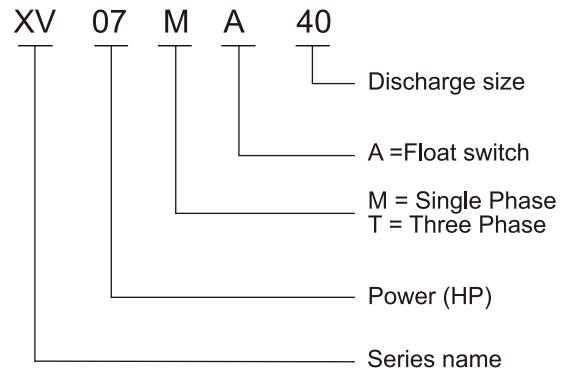

Applications

- Basement water removal
- Waste water drainage
- Water transfer
- Sump/effluent handling
- Dewatering
- Fish pond & fountain circulation
- Factory waste water handling

Motor Data

- Motor Type : 2 POLE , dry type
- Frequency : 60Hz
- Nominal Speed : 3450 rpm
- Insulation Class : F class (155°C)
- Enclosure Protection Class : IP 68
- Protection Device :
Thermal Protector (Single phase)

Pump Data

- Impeller : Open Impeller
- Shaft Seal / Mechanical :
Double Seals
- Bearing :
Double-shielded Ball Bearing

Operation Conditions

- Fluid Temperature: 0 to 35°C (95°F)

Material

No.	Component	Material
1	Cable	H07RN-F
2	Handle	AISI 304+Nylon
3	Motor Cover	AISI 304
4	Motor Casing	AISI 304
5	Fixing Ring	AISI 304
6	Pump Casing	AISI 304
7	Mechanical seal	Sic /Sic / NBR
8	Impeller	AISI 304
9	Key	AISI 304
10	Support Foot	AISI 304
11	Oil Seal	NBR
12	Shaft	AISI 304
13	V-type Axial Oil Seal	NBR
14	Suction flange	AISI 304

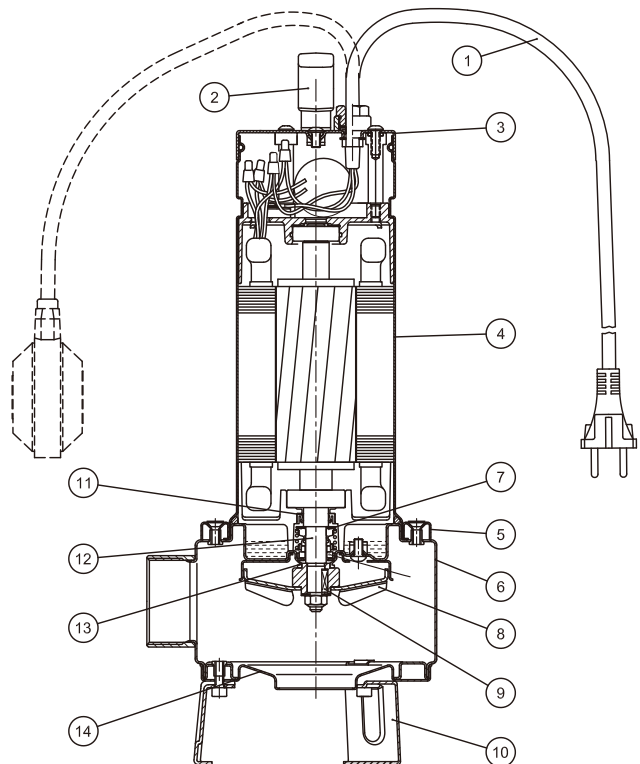

Submersible Drainage Pumps

60Hz

Performance Curves

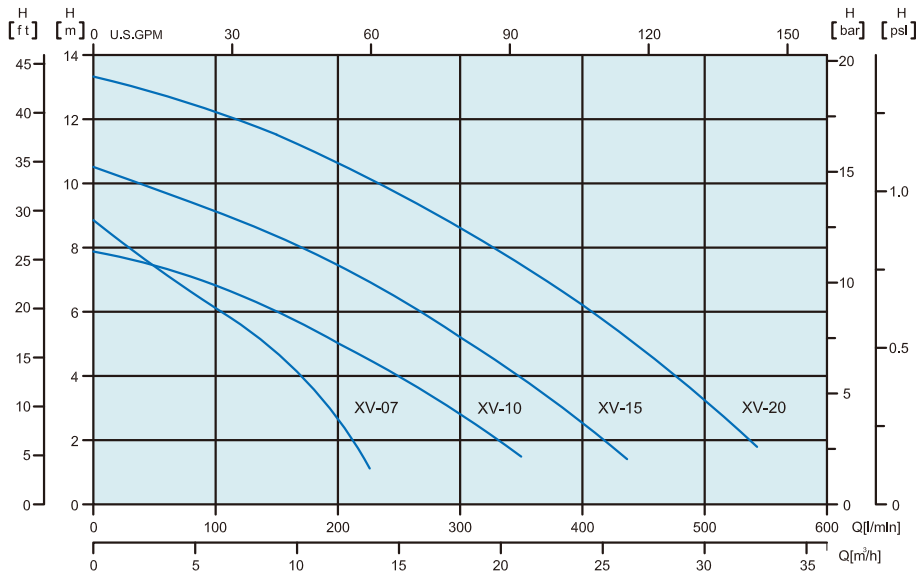

Technical Data

Single Phase

Model	Power		Current(A)		Capacitoret		Head		Flow		Discharge inch
	HP	Kw	110-127V	220-230V	110-127V UF / V	220-230V UF / V	Rated (M)	Max (M)	Rated (L/min)	Max (L/min)	
XV 07-M-40	0.75	0.55	8.8-8.0	4.7-4.5	20UF 350V	20UF 450V	6.5	8.8	80	230	1 1/2"
XV 07-MA-40											
XV 10-M-50	1.0	0.75	11.0-10.3	5.7-5.5	35UF 350V	22UF 450V	6.8	8.0	100	350	2"
XV 10-MA-50											
XV 15-M-50	1.5	1.1	-	8.0-7.7	-	30UF 450V	9.0	10.7	100	430	
XV 15-MA-50											

A = Auto Float Switch

Three Phase

Model	Power		Current(A)			Head		Flow		Discharge inch
	HP	Kw	220-230V	380-440V	460-480V	Rated (M)	Max (M)	Rated (L/min)	Max (L/min)	
XV 07-T-40	0.75	0.55	3.1-3.0	1.8-1.7	1.7-1.8	6.5	8.8	80	230	1 1/2"
XV 10-T-50	1.0	0.75	4.4-4.2	2.5-2.4	2.4-2.6	6.8	8.0	100	350	2"
XV 15-T-50	1.5	1	5.0-4.8	2.9-2.8	2.6-2.8	9.0	10.5	100	430	
XV 20-T-50	2.0	1.5	6.2-5.9	3.6-3.4	3.2-3.3	11.5	13.5	150	540	

Dimensions

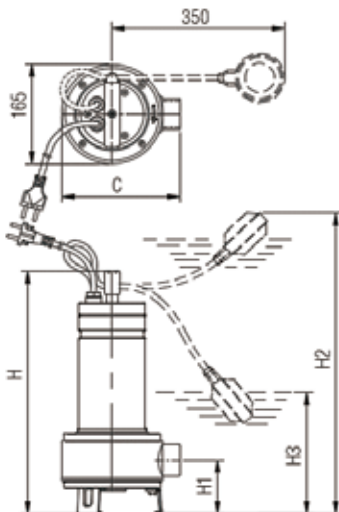

Model	Discharge[mm]					Solid Passage [mm]	Cable		N.W. [kg]
	H	H1	H2	H3	C		H07 RN-F	M	
XV 07-M-40	403	88.0	483	185	193	35	3G1.0mm²	5	9.0
								10	10.0
XV 07-MA-40	403	88.0	483	185	193	50	3G1.0mm²	5	10.0
								10	10.5
XV 10-M-50	486	111.5	566	268	198	50	3G1.0mm²	10	14.0
XV 10-MA-50	486	111.5	566	268	198	50	3G1.0mm²	10	14.5
XV 15-M-50	486	111.5	566	268	198	50	3G1.5mm²	10	16.0
XV 15-MA-50	486	111.5	566	268	198	50	3G1.5mm²	10	16.5
XV 07-T-50	403	88.0	-	-	193	35	4G1.0mm²	5	11.0
XV 10-T-50	436	111.5	-	-	198	50	4G1.0mm²	10	12.0
XV 15-T-50	486	111.5	-	-	198	50	4G1.0mm²	10	14.0
XV 20-T-50	486	111.5	-	-	198	50	4G1.5mm²	10	16.0



 **STAIRS**

No. 3-8, Sanchial Tsun, Lutsao Hsiang, Chiayi County, Taiwan, R.O.C.
Tel: +886 5 3750488 Fax: +886 5 3752330
www.stairs.com.tw E-mail: stairs@stairs.com.tw

1130820